

PLAT OF SURVEY OF 616 DUKE LANE
FORT COLLINS, COLORADO

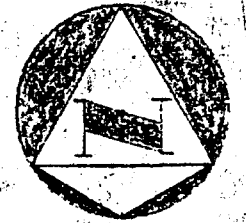

SCALE: 1" = 20'

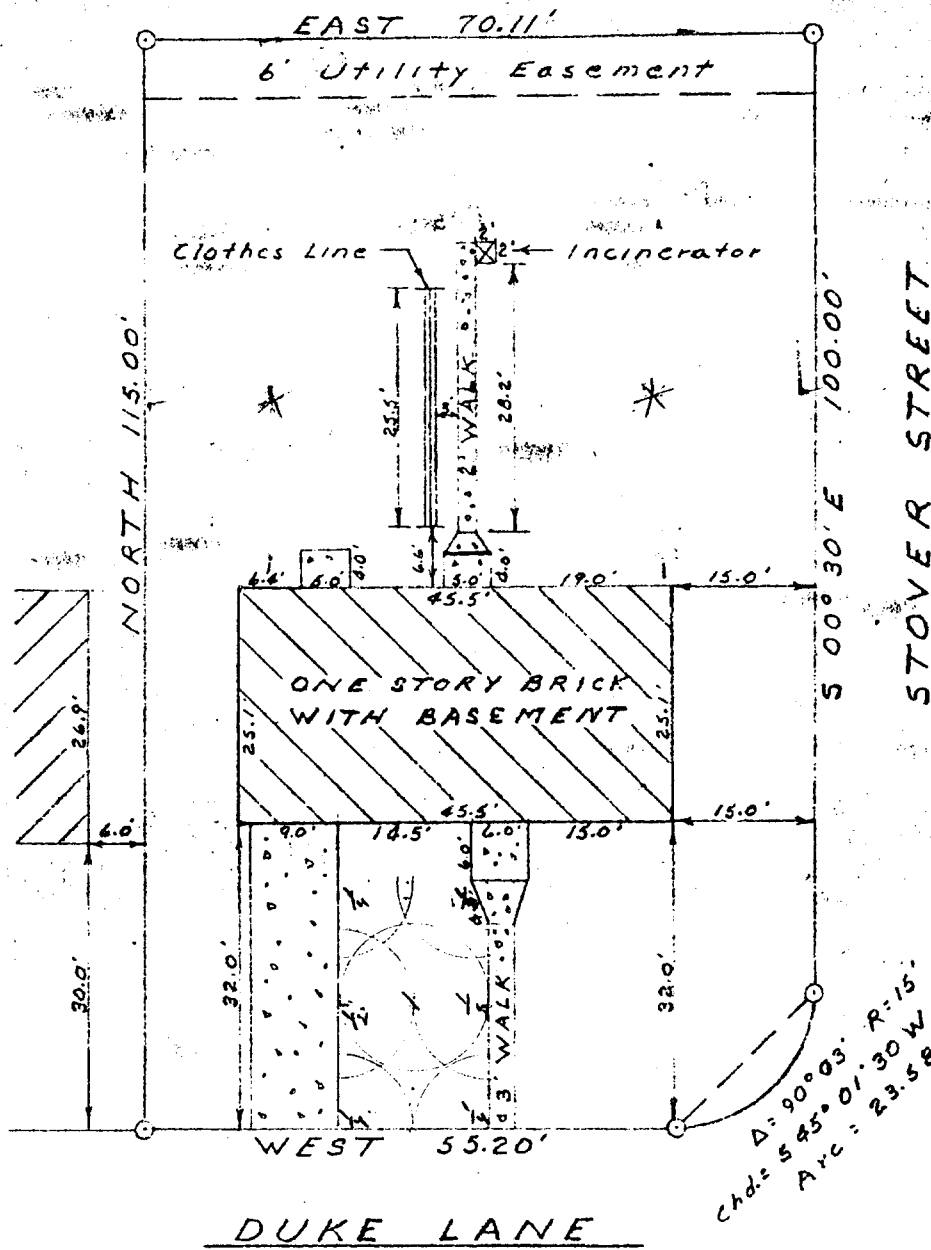

DUKE LANE

$\Delta = 90^{\circ} 03'$ $R = 15'$
Chd. = 23.58' $\text{Arc} = 21.22'$

4/16/61

CERTIFICATE

This is to certify that on the 21st day September, A.D. 1961, a survey was made under my supervision of 616 Duke Lane, which is Lot 1, Block 11, South College Heights Seventh Subdivision, Fort Collins, Colorado, and the one-story brick residence with basement was found to be entirely within the property lines, as shown on this plat. The location and dimensions of all easements, buildings, improvements, and rights-of-way in evidence or known to me and all encroachments by or on the premises are accurately shown.

James H. Stewart
James H. Stewart, P.E. & L.S.