

CITY OF FORT COLLINS
 WOODBURNING STOVE PLAN

28058

ADDRESS: 916 CHEYENNE DRIVE

YOUR STOVE:

MAKE COUNTRY FLAME

MODEL S

A. THE AREA TO THE RIGHT IS THE ROOM IN WHICH YOU ARE LOCATING YOUR STOVE. SKETCH IN THE FOLLOWING:

1. Room Dimensions
2. Window and Door Location
3. Hearth and Stove

B. HEARTH

Material BRICK

Dimensions 16' x 10'

C. STOVE LOCATION

Minimum Clearances to Wall (As Required by manufacturer).

Front NA

Back NA

Sides (L) _____ (R) _____

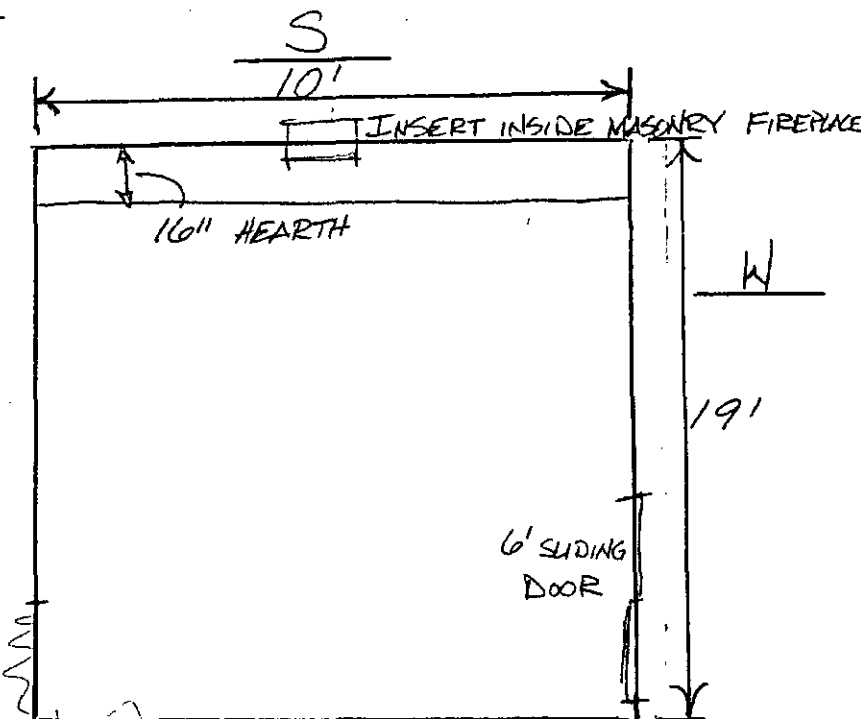

Reduced Clearances with Heat Shield

Front _____ Back _____

Sides (L) _____ (R) _____

D. HEAT SHIELD (If applicable; must be approved)

Material NA

Length NA

Height NA

E. CHIMNEY INSTALLATION

Check the one that most nearly resembles your installation.

General Requirements:

1. Single wall pipe may be used only to wall or ceiling penetration and requires 18" clearance to combustible walls.
2. Horizontal runs must slope 1/4" per foot.
3. Double or triple wall pipe must be listed by an approved testing agency and generally requires 2" clearance to combustibles (the requirement is on the pipe).
4. The chimney termination must extend 2' above the highest point within a 10' radius and be protected with a

