

PLAN VIEW  
VERTICAL CURB, GUTTER AND SIDEWALK

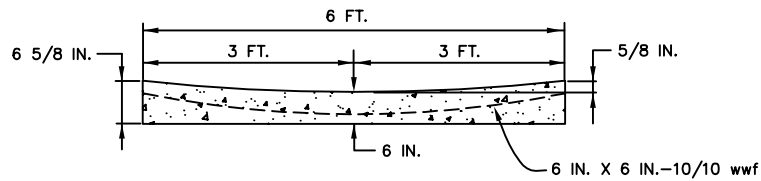

SECTION A-A

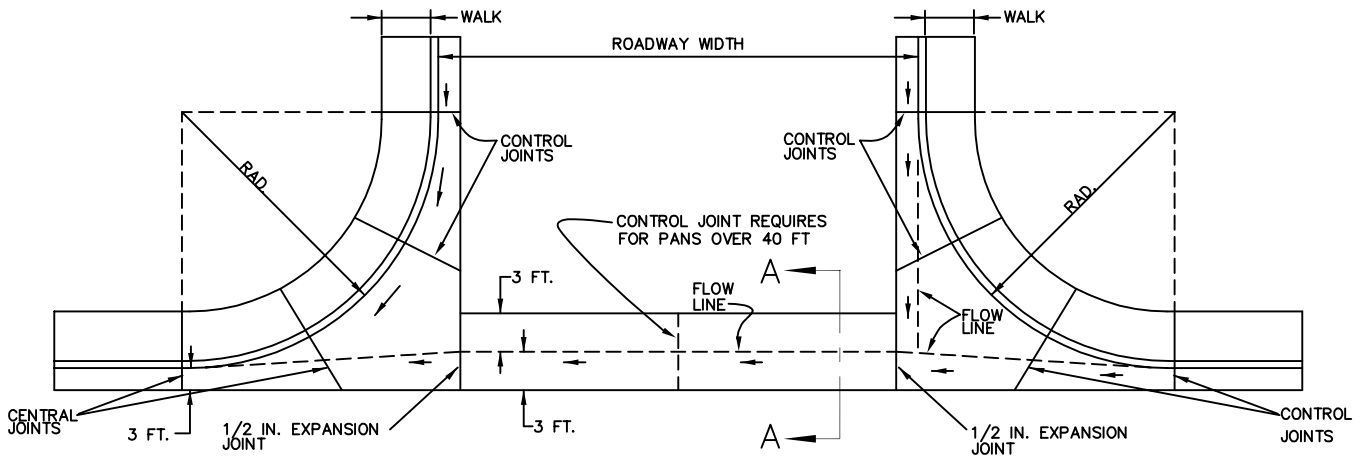

PLAN VIEW  
DRIVE-OVER CURB, GUTTER AND SIDEWALK

GENERAL NOTES:

1. 6 IN. X 6 IN. X 10/10 WWF SHALL BE INSTALLED IN RADIUS AND PAN.
2. MINIMUM 6 IN. WIDE PAN FOR RESIDENTIAL STREET.
3. MINIMUM 10 FT. WIDE PAN FOR ARTERIAL AND COLLECTOR STREETS.

STREET INTERSECTION GUTTER DETAIL WITH CROSS PAN



CITY OF  
FORT COLLINS  
UTILITIES  
FORT COLLINS, CO.  
(970) 221-6700

STORMWATER  
CONSTRUCTION DETAILS

APPROVED:

DATE: 12/22/00

DRAWN BY: NBJ

DETAIL

D-14