

AGENDA ITEM SUMMARY

FORT COLLINS CITY COUNCIL

ITEM NUMBER: 30 A-CC

DATE: May 4, 1999

STAFF: Ron Mills

SUBJECT:

Routine Easements.

RECOMMENDATION:

Staff recommends acceptance of the easements described below.

EXECUTIVE SUMMARY:

- A. Easement from Front Range Baptist Church to the City for installation of a fire hydrant and underground utilities needed for Miramont Office Park at 623 East Harmony Road. Monetary consideration: \$0. (Map #1)
- B. Permanent utility easement from Mack and Jacquine Anderson, located on the south side of LaPorte Avenue, between College Avenue and Mason Street. Monetary consideration: \$10. (Map #2)
- C. Drainage easement from Mack and Jacquine Anderson, located on the south side of LaPorte Avenue, between College Avenue and Mason Street. Monetary consideration: \$10. (Map #3)
- D. Drainage Easement from Leonard and Mary Ann Maes, located on the west side of South Taft Hill Road and south of County Road 38E. Monetary consideration: \$10. (Map #4)
- E. Two drainage easements from S-B Properties No. 22, Limited Partnership, located east of McMurry Avenue, between Harmony Road and Monte Carlo Drive. Monetary consideration: \$10. (Map #5)
- F. Drainage easement from Elizabeth Center Co., LLP, located east of City Park Avenue and north of West Elizabeth Street. Monetary consideration: \$10. (Map #6)
- G. Drainage easement from Collins Campus West, LLC, located east of City Park Avenue and north of West Elizabeth Street. Monetary consideration: \$10. (Map #7)
- H. Drainage easement from Sharp Point Properties, LLC, located on the east side of Midpoint Drive and south of Prospect Road. Monetary consideration: \$10. (Map #8)

- I. Drainage easement from 1725 Sharp Point LLC, located on the west side of Sharp Point Drive and south of Prospect Road. Monetary consideration: \$10. (Map #9)
- J. Three utility easements from Sharp Point Properties, LLC, located on the east side of Midpoint Drive and south of Prospect Road. Monetary consideration: \$10. (Map #10)
- K. Drainage easement from Timberline Partners, Limited, LLLP, located on the east side of Midpoint Drive and south of Prospect Road. Monetary consideration: \$10. (Map #11)
- L. Access and drainage easement from Timberline Partners, Limited, LLLP, located on Lot 23, Prospect Park Industrial Park. Monetary consideration: \$10. (Map #12)
- M. Access easement from Timberline Partners, Limited, LLLP, located on the west side of Timberline Road and south of East Horsetooth Road. Monetary consideration: \$10. (Map #13)
- N. Utility and drainage easement from Timberline Partners, Limited, LLLP, located on the west side of Timberline Road and south of Horsetooth Road. Monetary consideration: \$10. (Map #14)
- O. Grading easement from Timberline Partners, Limited, LLLP, located west of Timberline Road and south of Horsetooth Road. Monetary consideration: \$10. (Map #15)
- P. Access easement from Timberline Partners, Limited, LLLP, located on the west side of Timberline Road and south of Horsetooth. Monetary consideration: \$10. (Map #16)
- Q. Access, utility and drainage easement from Timberline Partners, Limited, LLLP, located east of Automation Way and south of Horsetooth Road. Monetary consideration: \$10. (Map #17)
- R. Access, utility and drainage easement from Timberline Partners, Limited, LLLP, located west of Timberline Road and south of Horsetooth Road. Monetary consideration: \$10. (Map #18)
- S. Drainage easement from the Poudre Valley Hospital District, located on the southeast corner of East Harmony Road and Timberline Road. Monetary consideration: \$10. (Map #19)
- T. Drainage easement from the Poudre Valley Hospital District, located on the southeast corner of East Harmony Road and Timberline Road. Monetary consideration: \$10. (Map #20)
- U. Utility easement from the Poudre Valley Hospital District, located on the southeast corner of East Harmony Road and Timberline Road. Monetary consideration: \$10. (Map #21)
- V. Utility easement from the Poudre Valley Hospital District, located on the southeast corner of East Harmony Road and Timberline Road. Monetary consideration: \$10. (Map #22)
- W. Utility easement from the Poudre Valley Hospital District, located on the southeast corner of East Harmony Road and Timberline Road. Monetary consideration: \$10. (Map #23)

- X. Utility easement from the Poudre Valley Hospital District, located on the southeast corner of East Harmony Road and Timberline Road. Monetary consideration: \$10. (Map #24)
- Y. Utility easement from the Poudre Valley Hospital District, located on the southeast corner of East Harmony Road and Timberline Road. Monetary consideration: \$10. (Map #25)
- Z. Utility, access and drainage easement from the Poudre Valley Hospital District, located on the southeast corner of East Harmony Road and Timberline Road. Monetary consideration: \$10. (Map #26)
- AA. Utility, access and drainage easement from the Poudre Valley Hospital District, located on the southeast corner of East Harmony Road and Timberline Road. Monetary consideration: \$10. (Map #27)
- BB. Drainage easement from the Poudre Valley Hospital District, located on the southeast corner of East Harmony Road and Timberline Road. Monetary consideration: \$10. (Map #28)
- CC. Right-of-way easement from the Poudre Valley Hospital District, located on the southeast corner of East Harmony Road and Timberline Road. Monetary consideration: \$10. (Map #29)

Front Range Baptist Church Easement Location Map

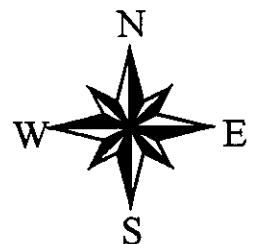
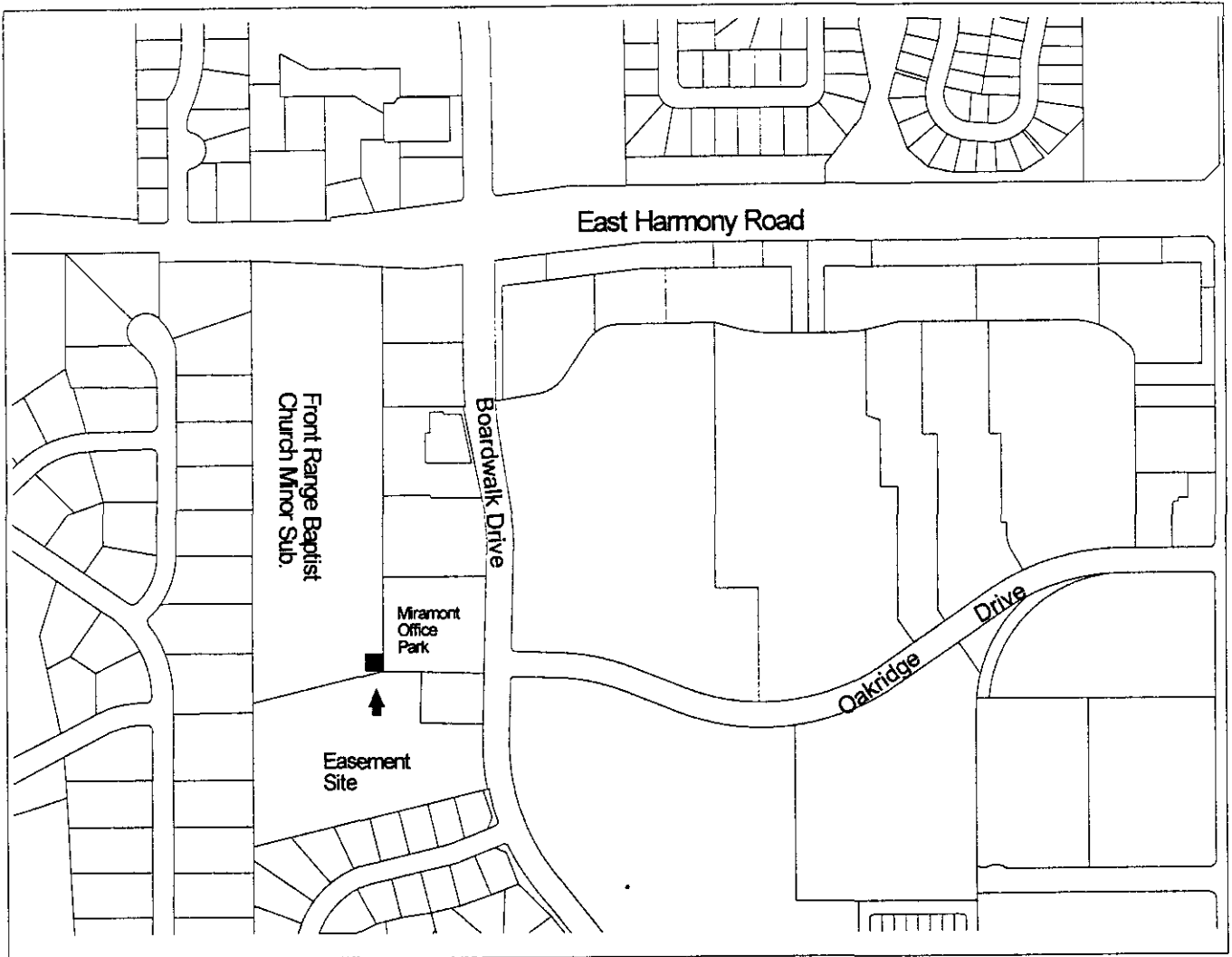

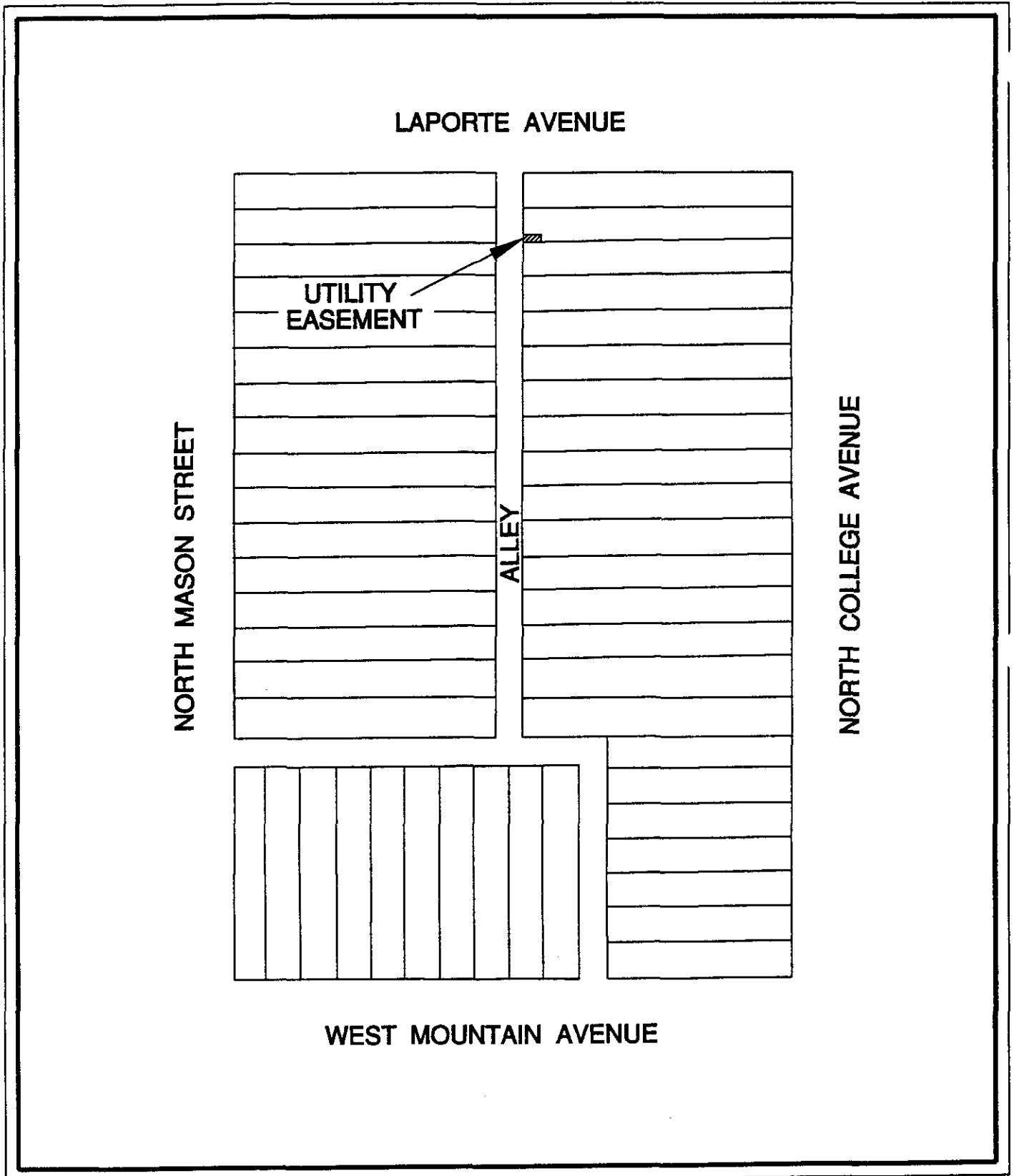

VICINITY MAP
Proposed
Utility Easement

03/09/99
NTS



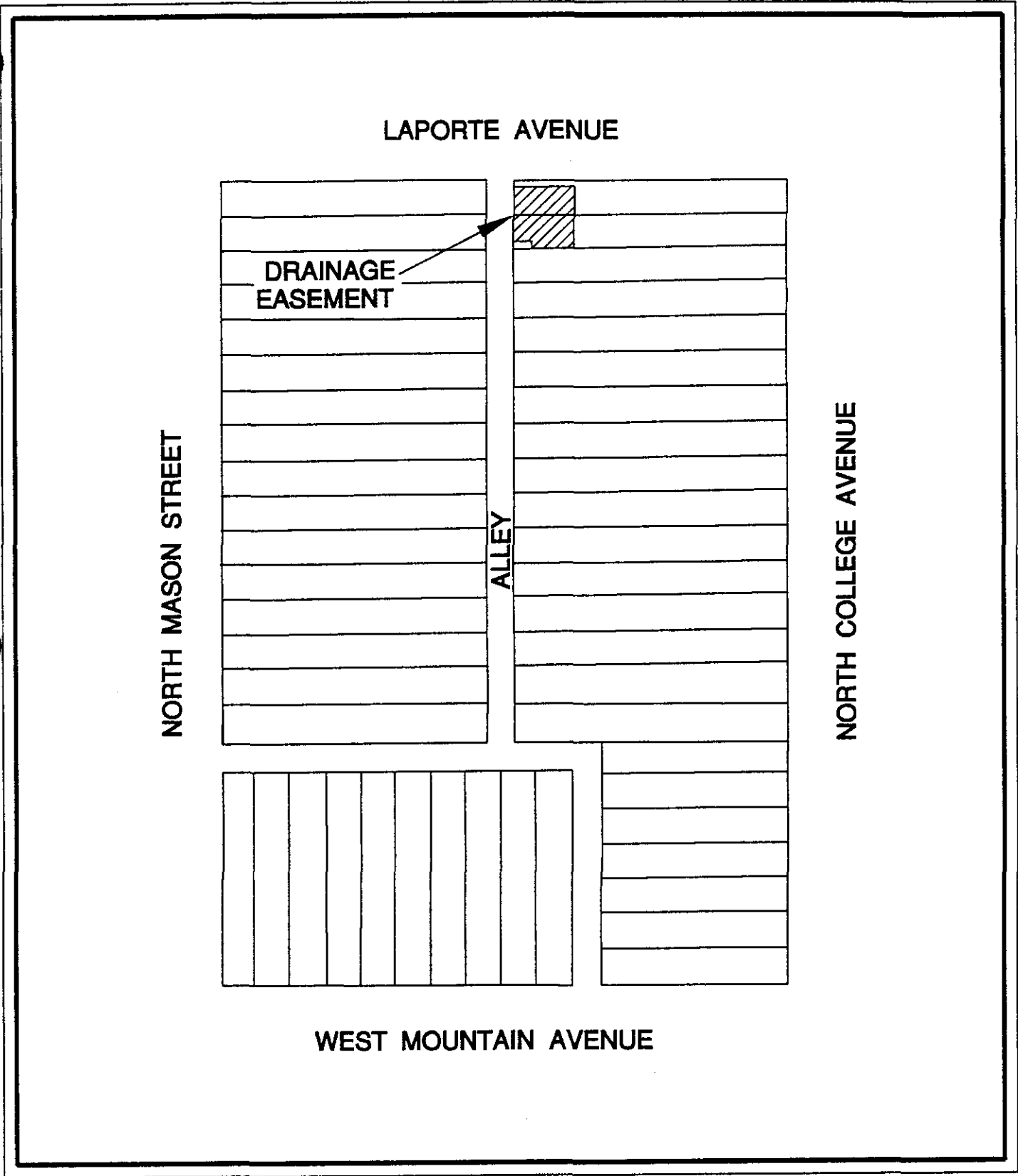

VICINITY MAP
Proposed
Drainage Easement

03/09/99
NTS



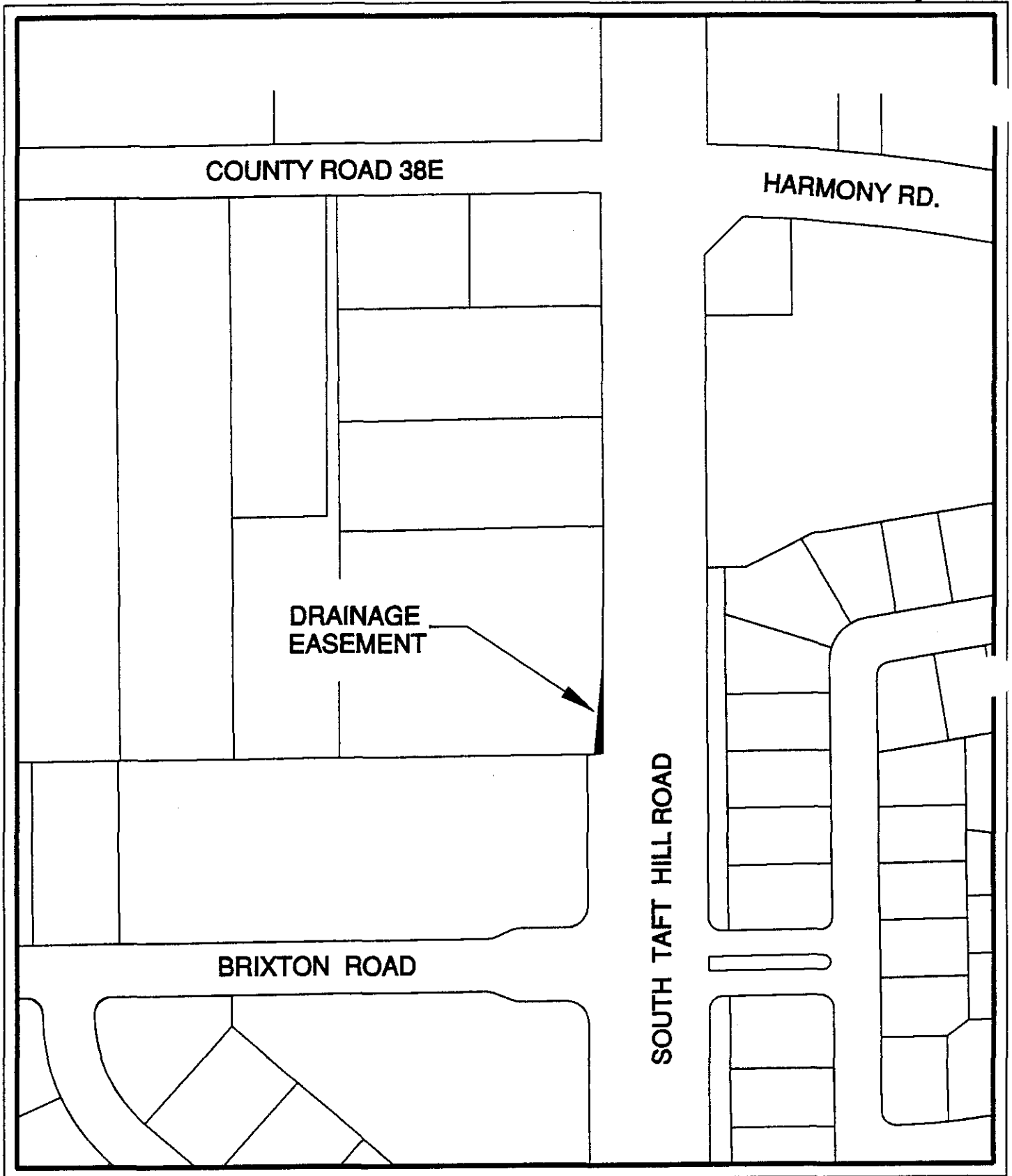

VICINITY MAP
Proposed
Drainage Easement

04/12/99
NTS



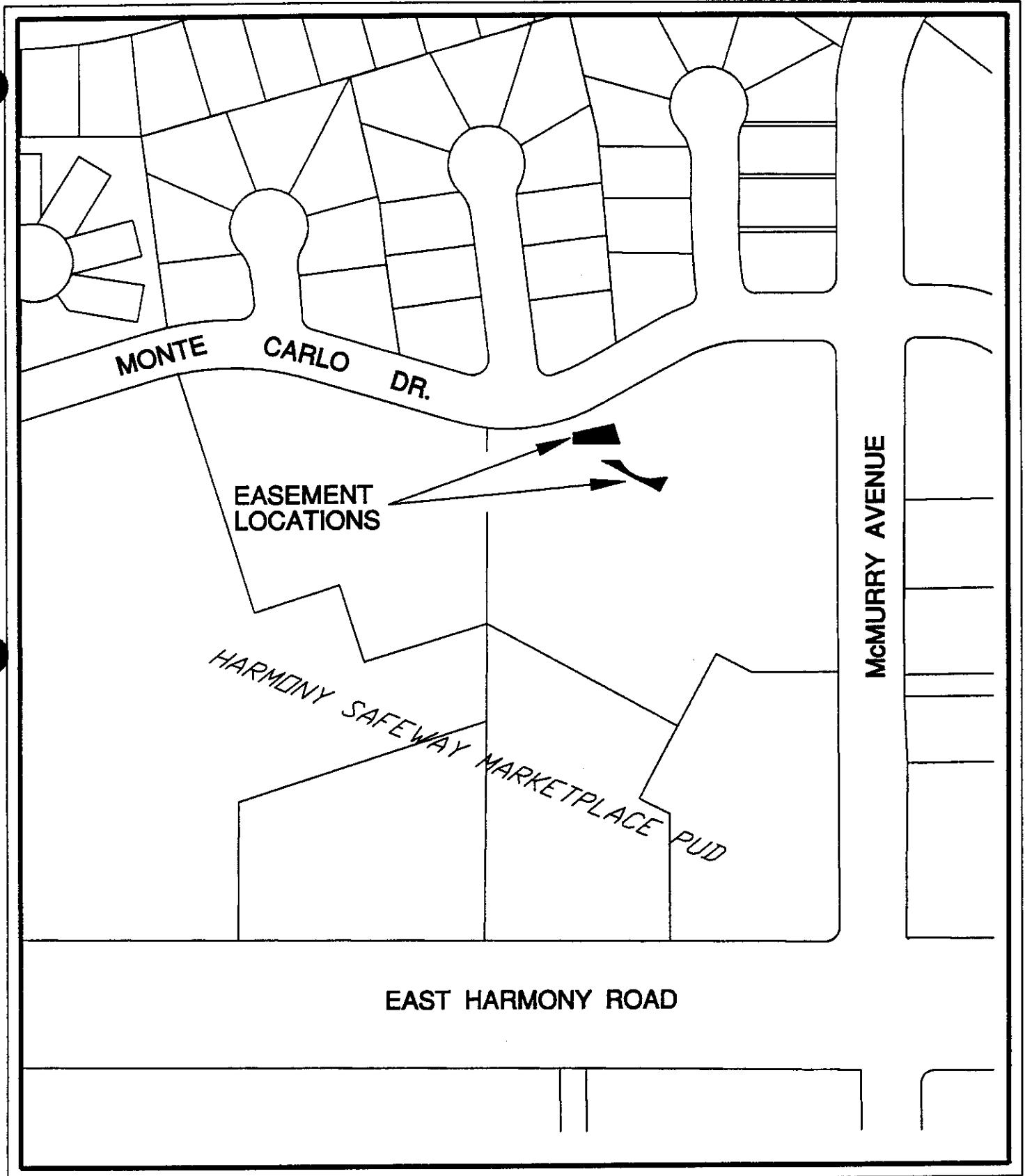

VICINITY MAP
Proposed
Drainage Easements

04/12/99
NTS



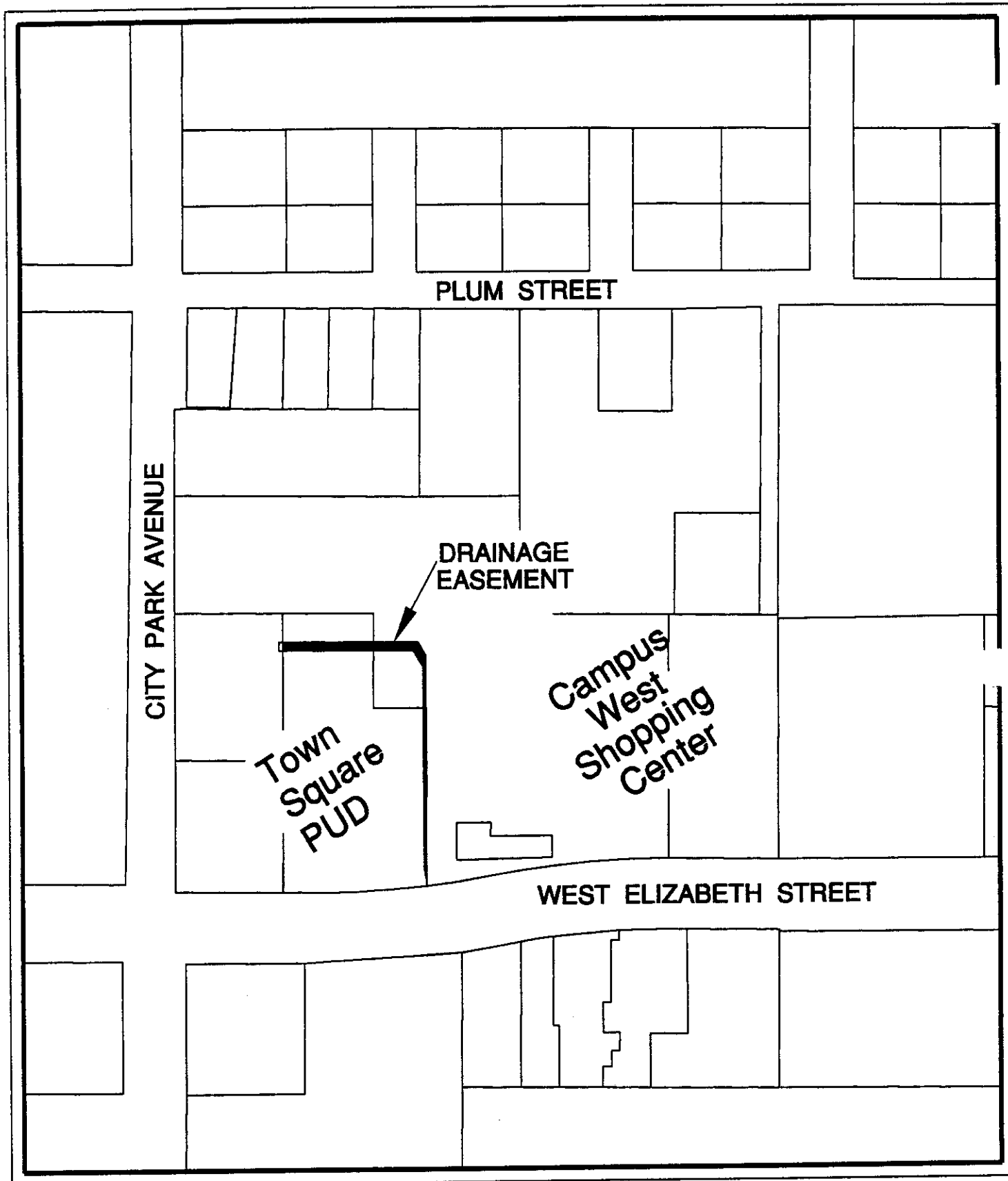

VICINITY MAP
Proposed
Drainage Easement

04/20/99
NTS



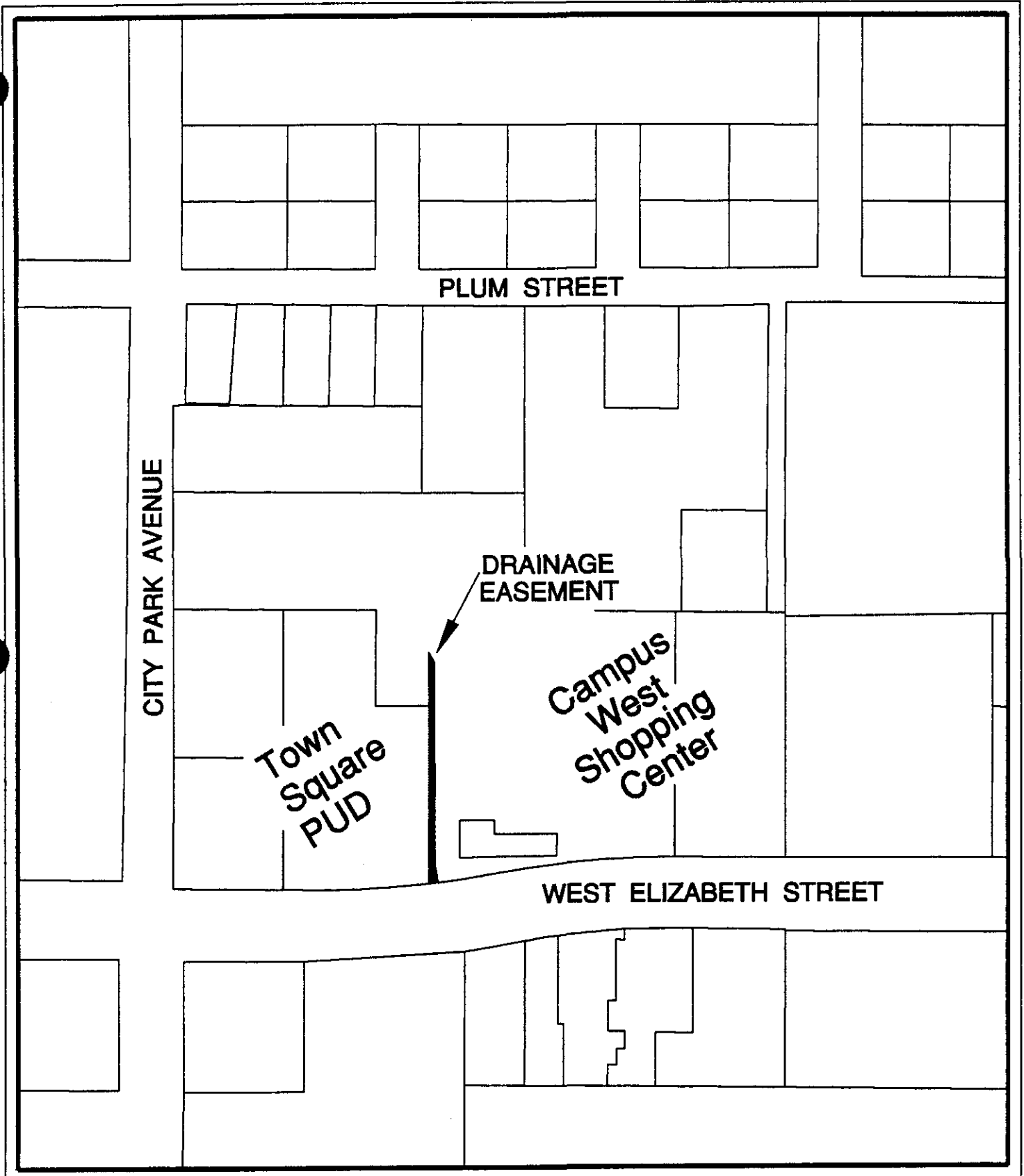

VICINITY MAP
Proposed
Drainage Easement

04/20/99
NTS



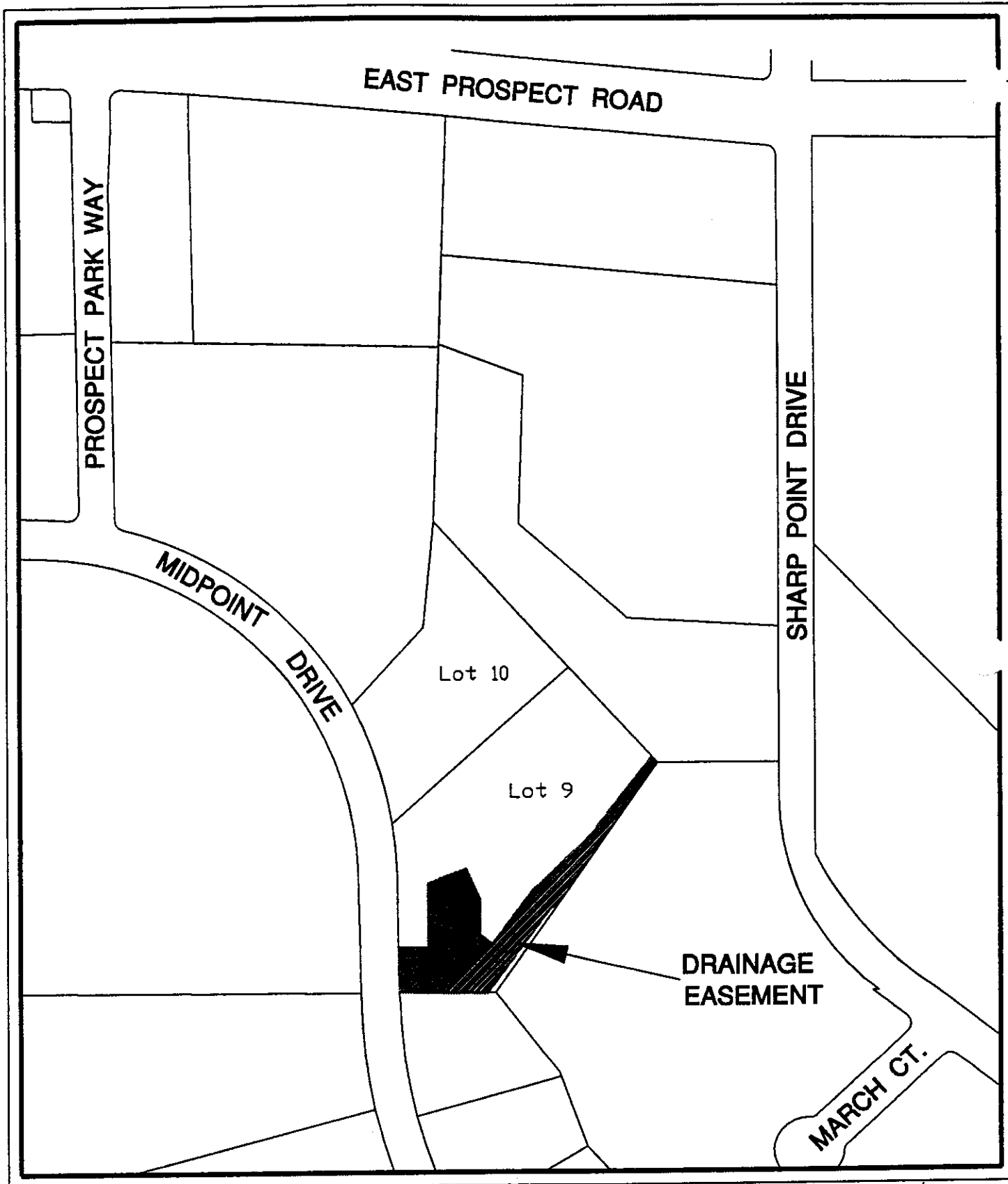

VICINITY MAP
Proposed
Drainage Easement

04/19/99
NTS



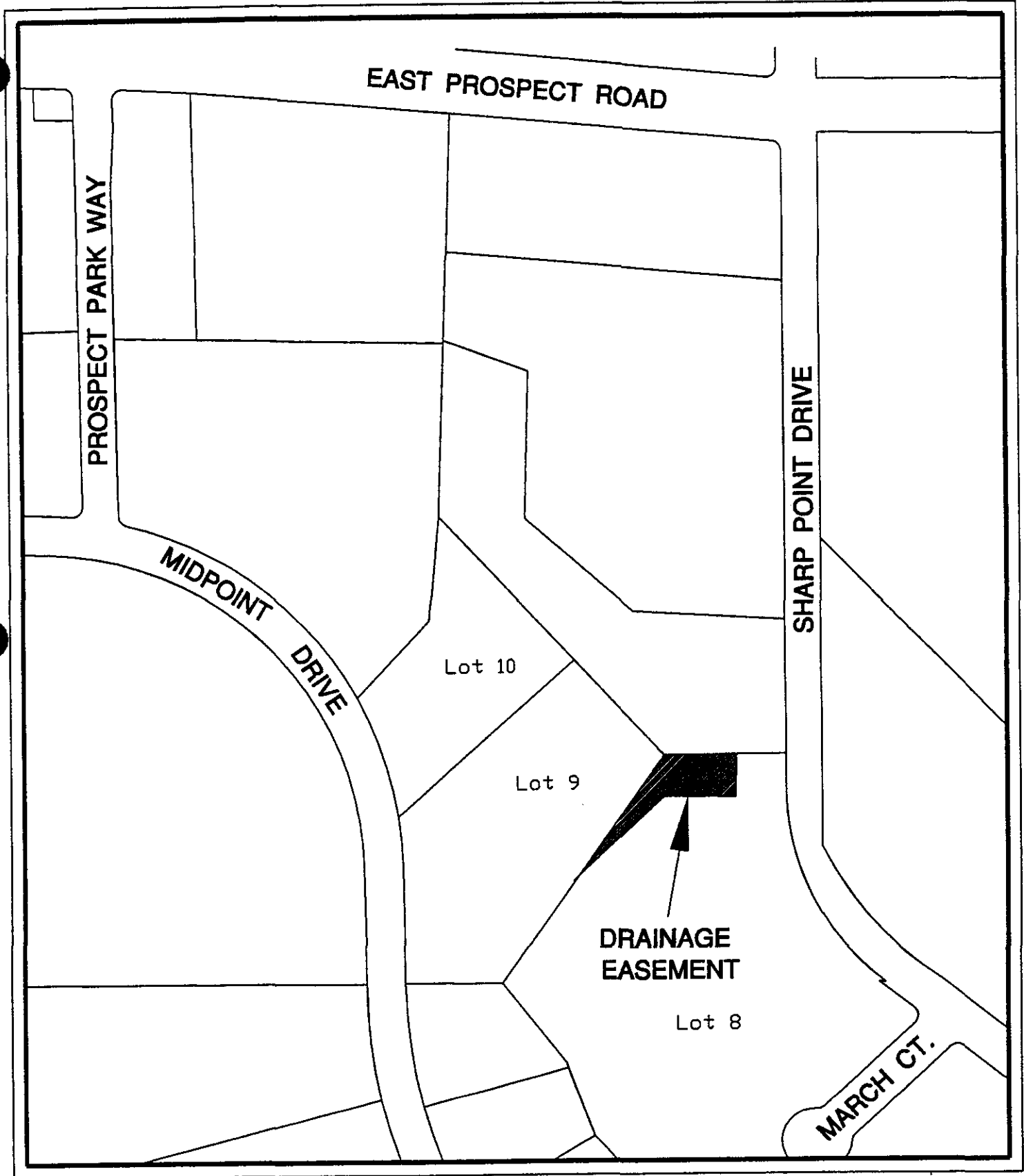

VICINITY MAP
Proposed
Drainage Easement

04/19/99
NTS



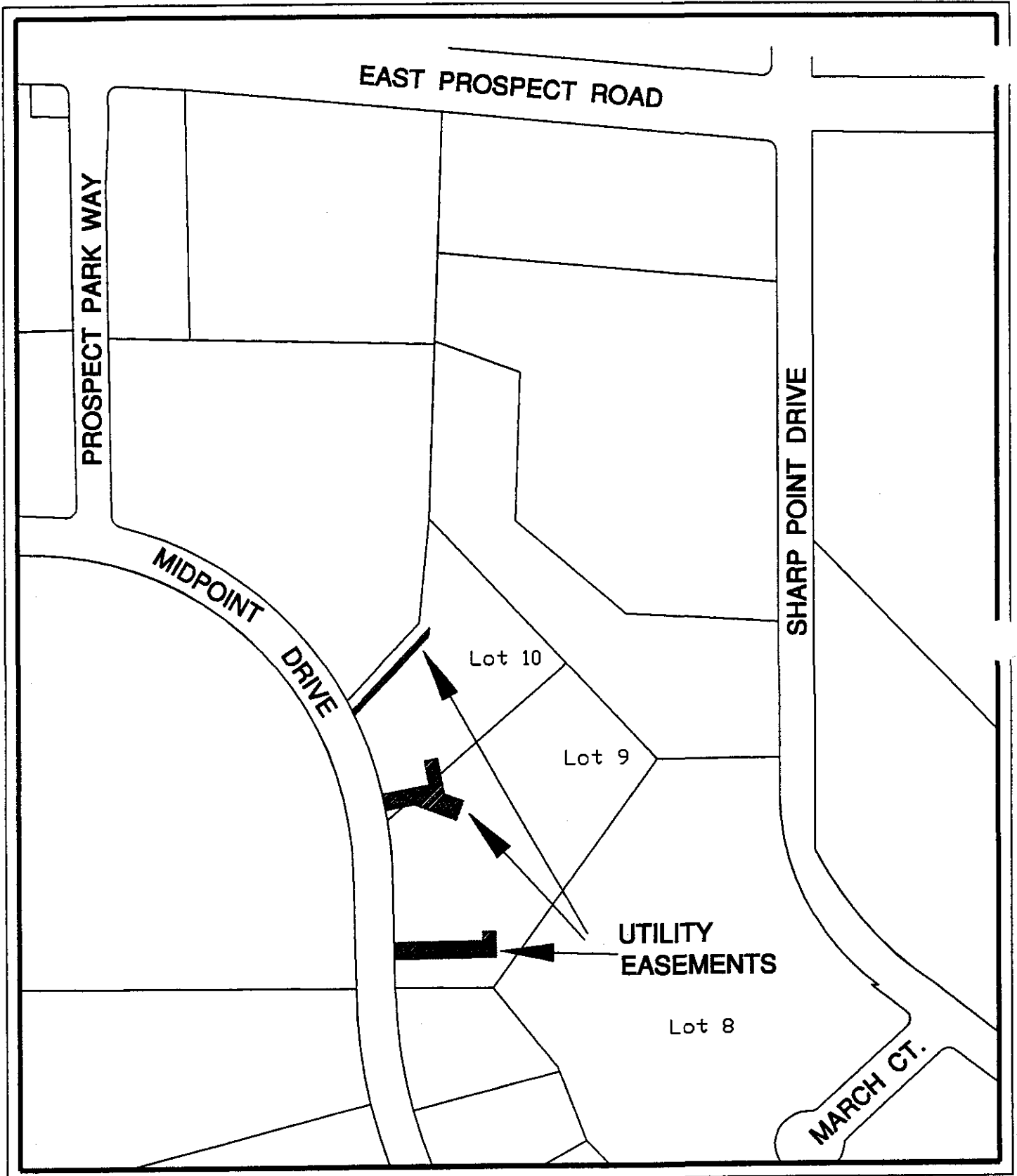

VICINITY MAP
Proposed
Utility Easement

04/19/99
NTS



Map #11

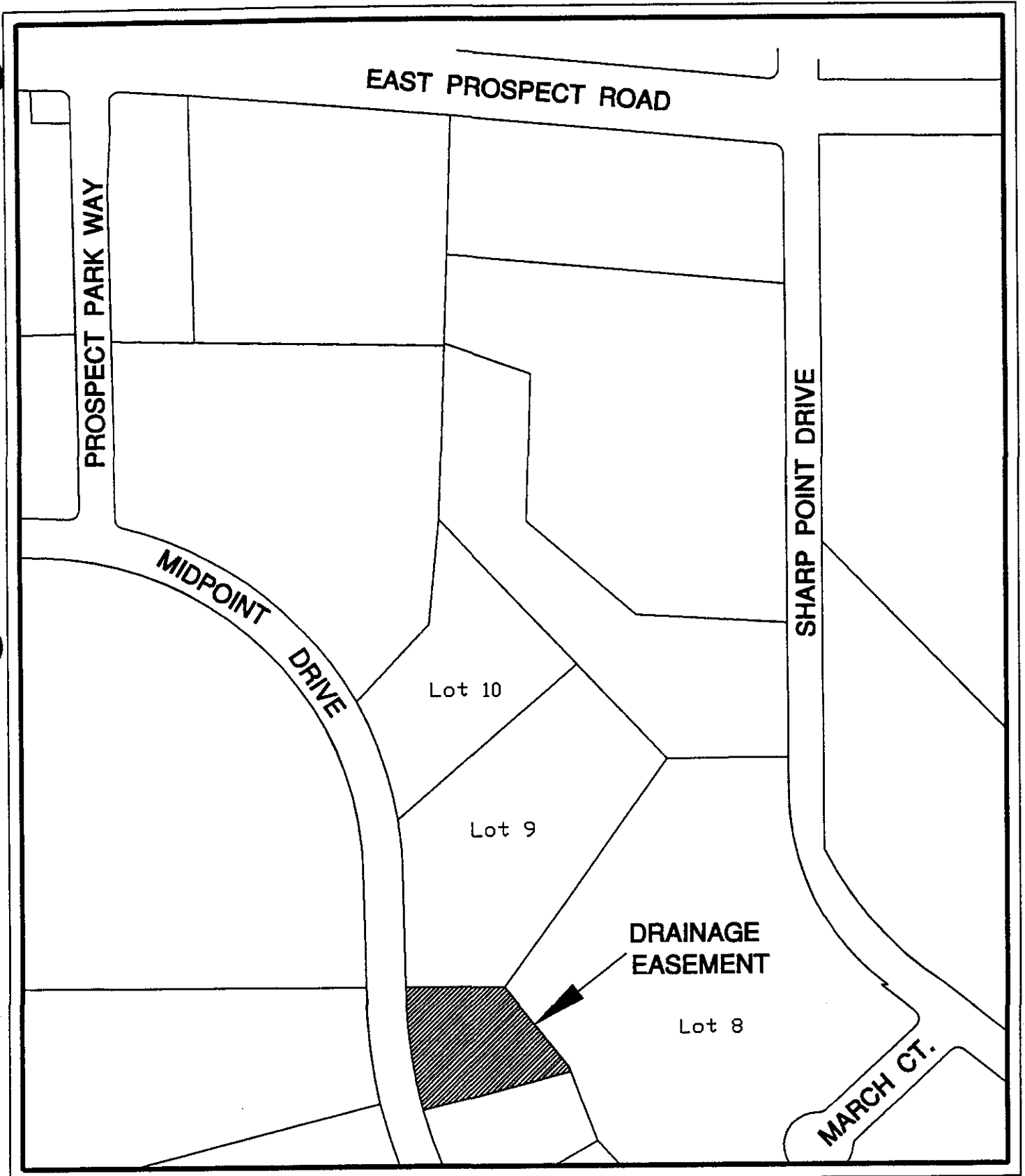

VICINITY MAP
**Proposed
Drainage Easement**

04/19/99
NTS



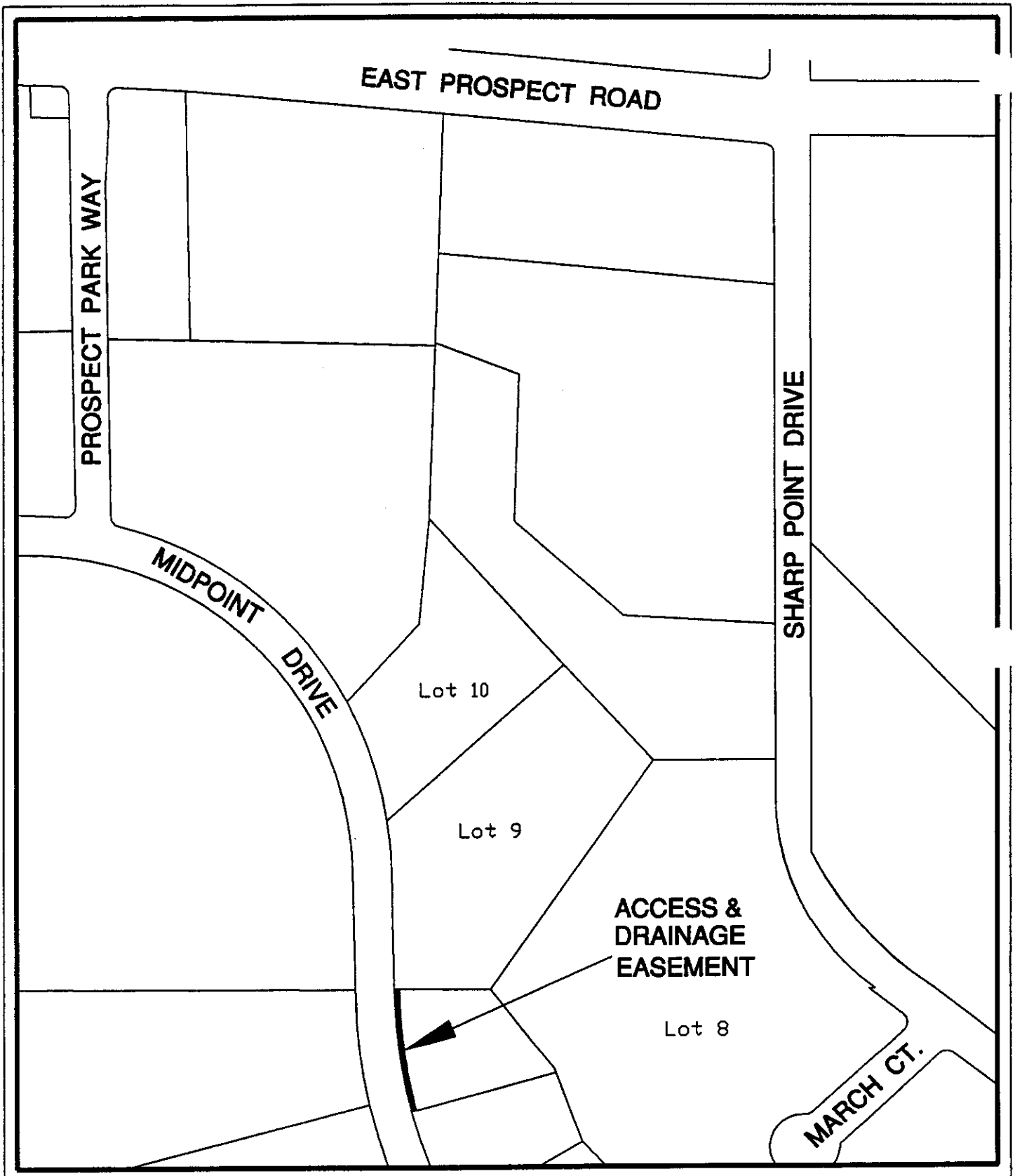

VICINITY MAP
Proposed
Access and Drainage Easement

04/19/99
NTS



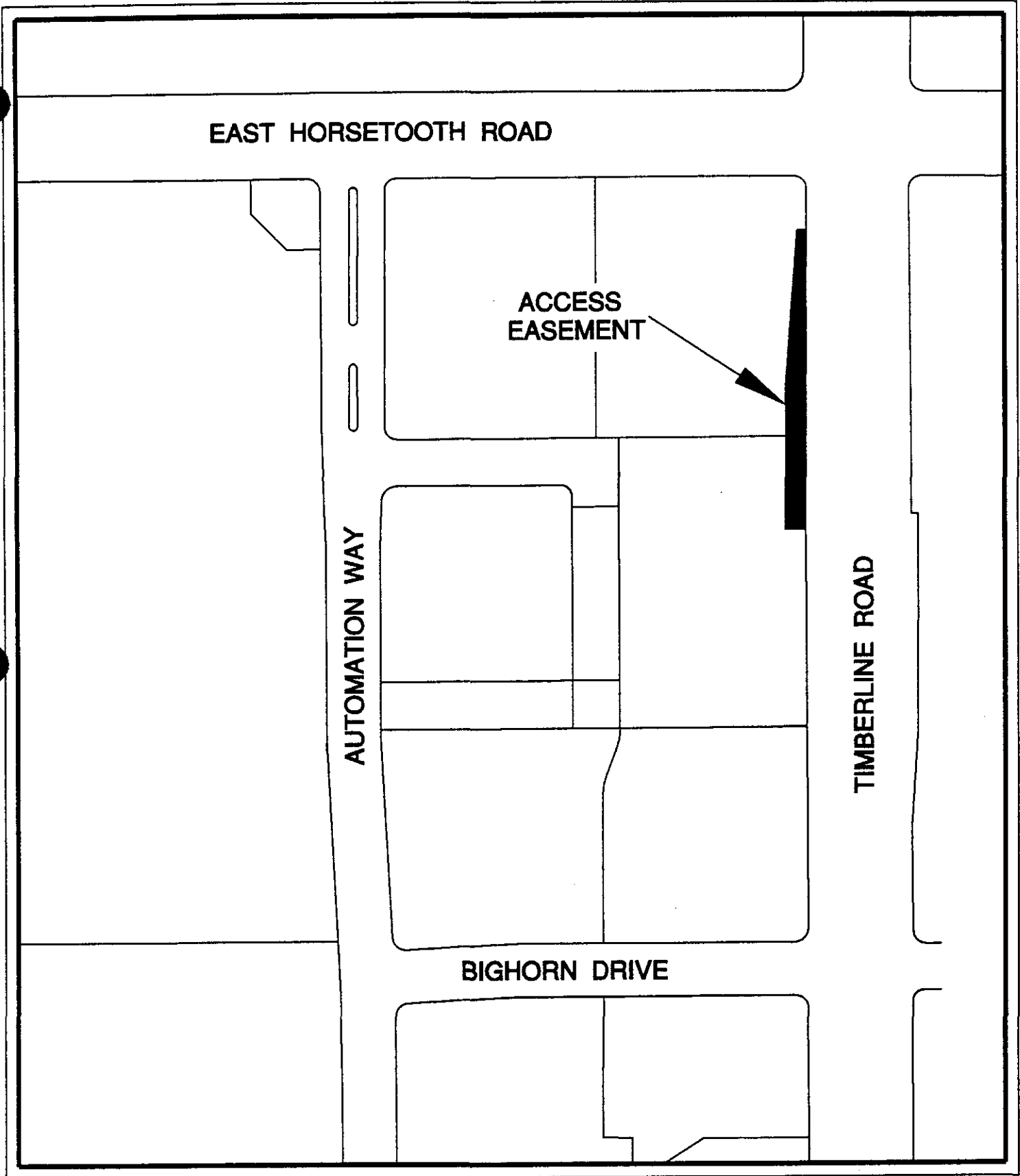

VICINITY MAP
Proposed
Access Easement

04/12/99
NTS



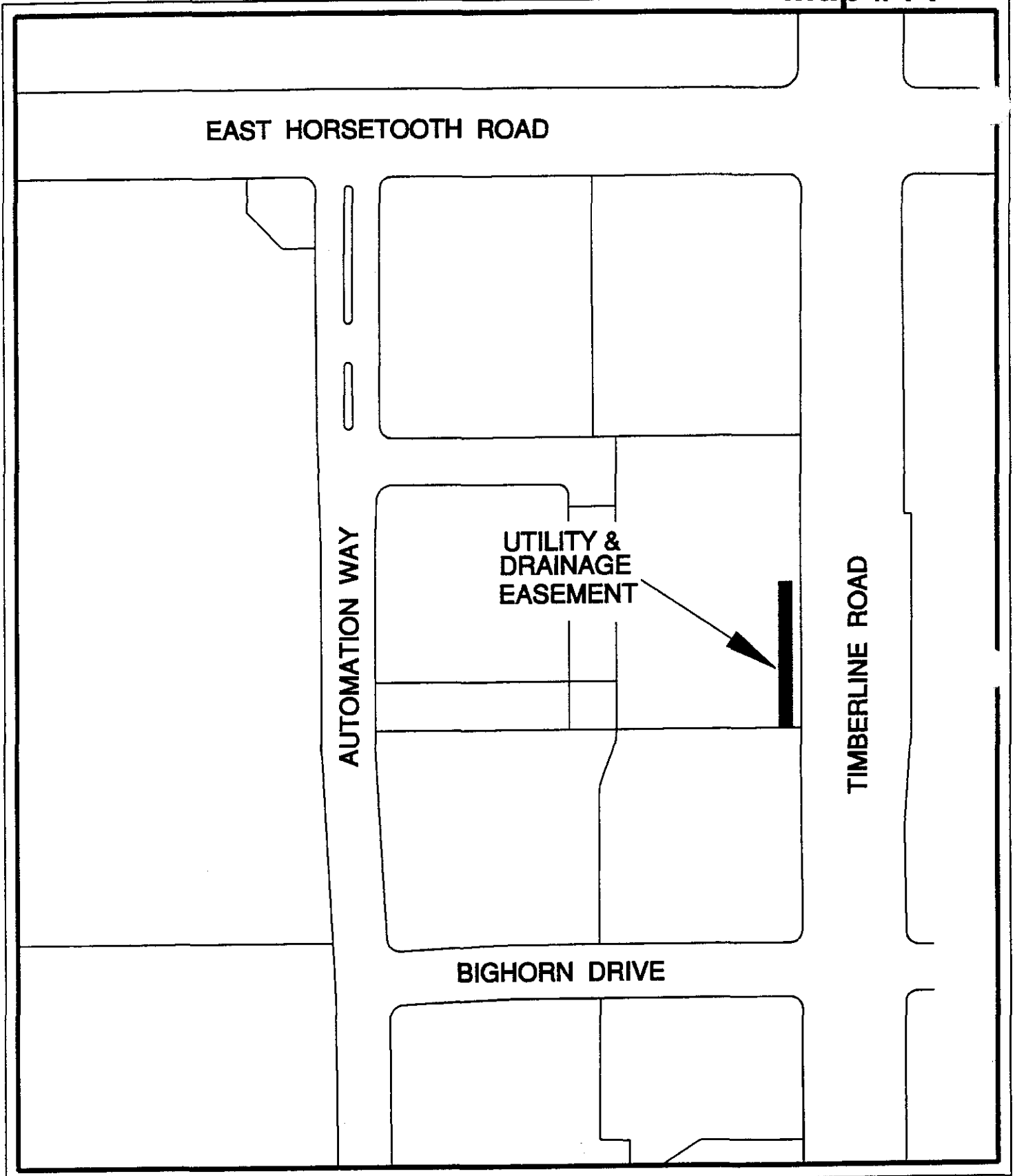

VICINITY MAP
Proposed
Utility & Drainage Easement

04/12/99
NTS



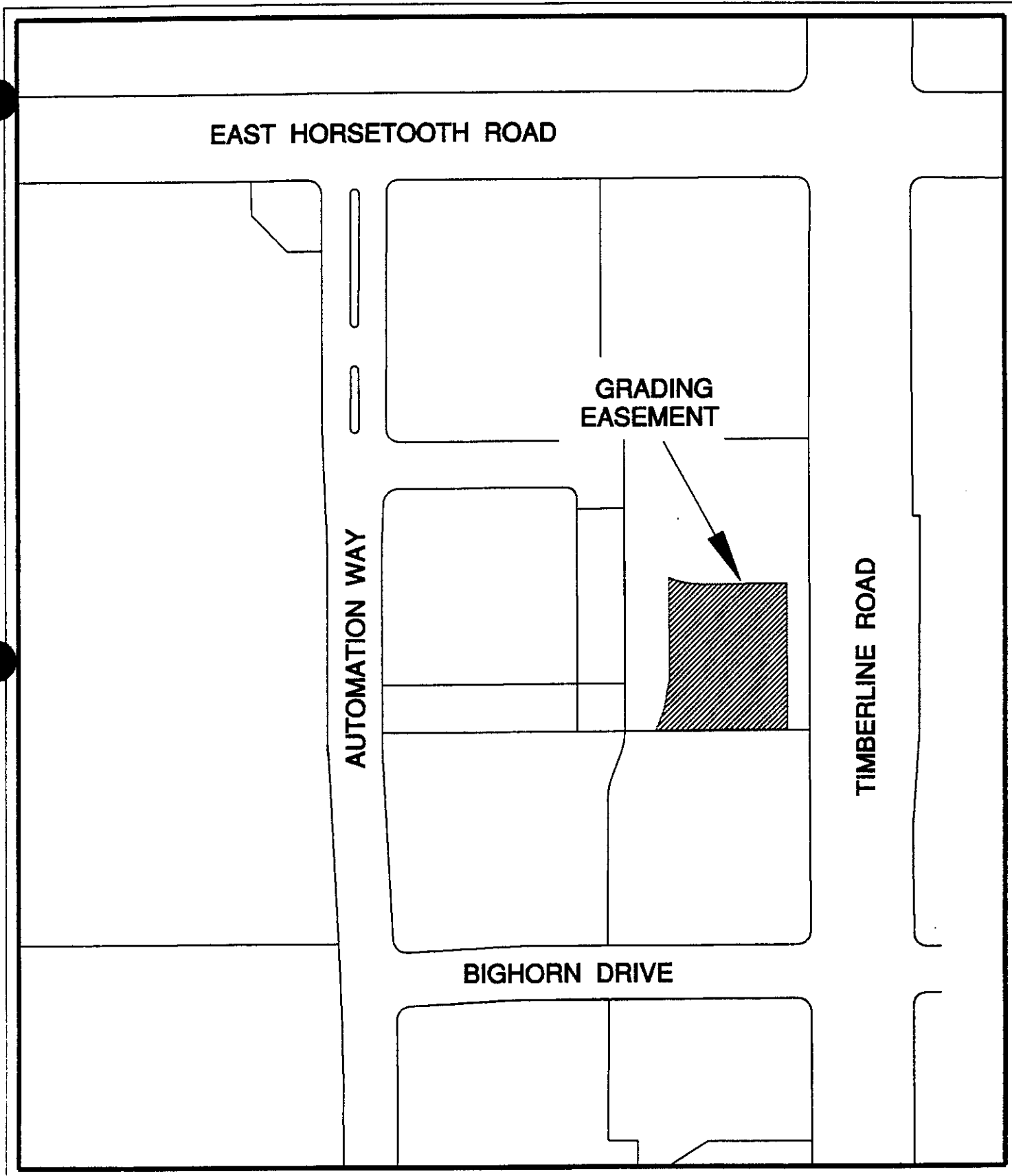

VICINITY MAP
Proposed
Grading Easement

04/12/99
NTS



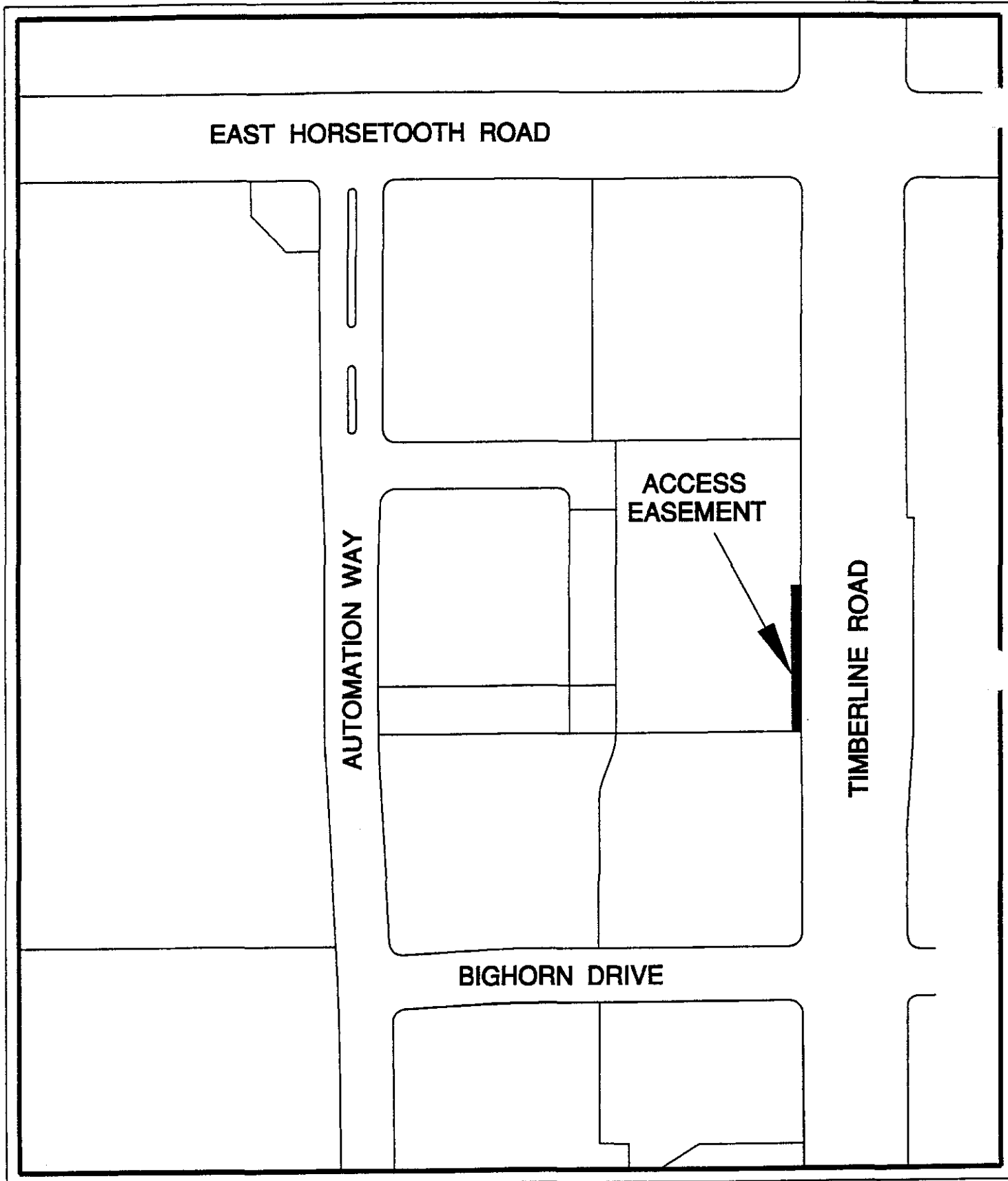

VICINITY MAP
Proposed
Access Easement

04/12/99
NTS



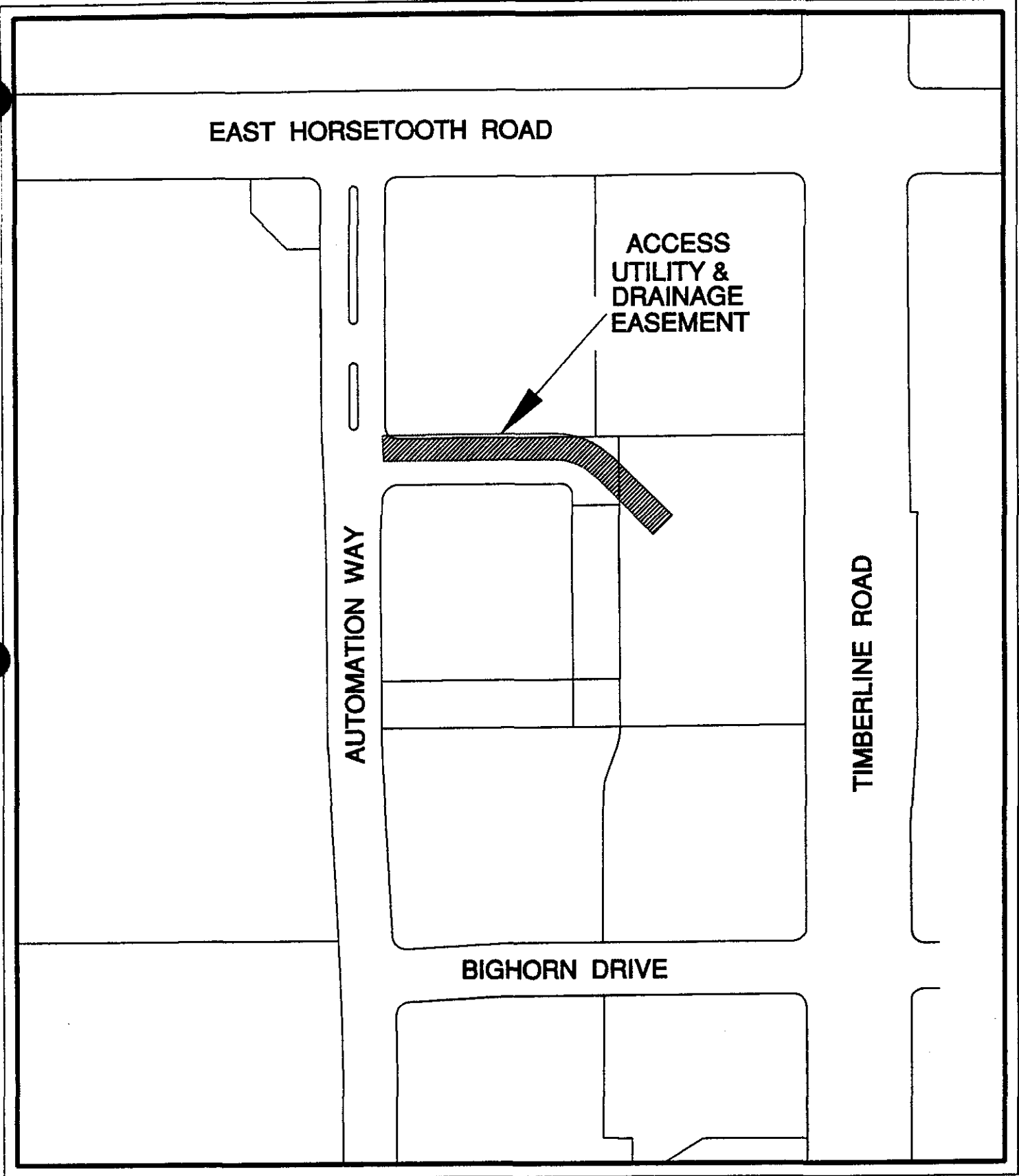

VICINITY MAP
Proposed Access,
Utility & Drainage Easement

04/12/99
NTS



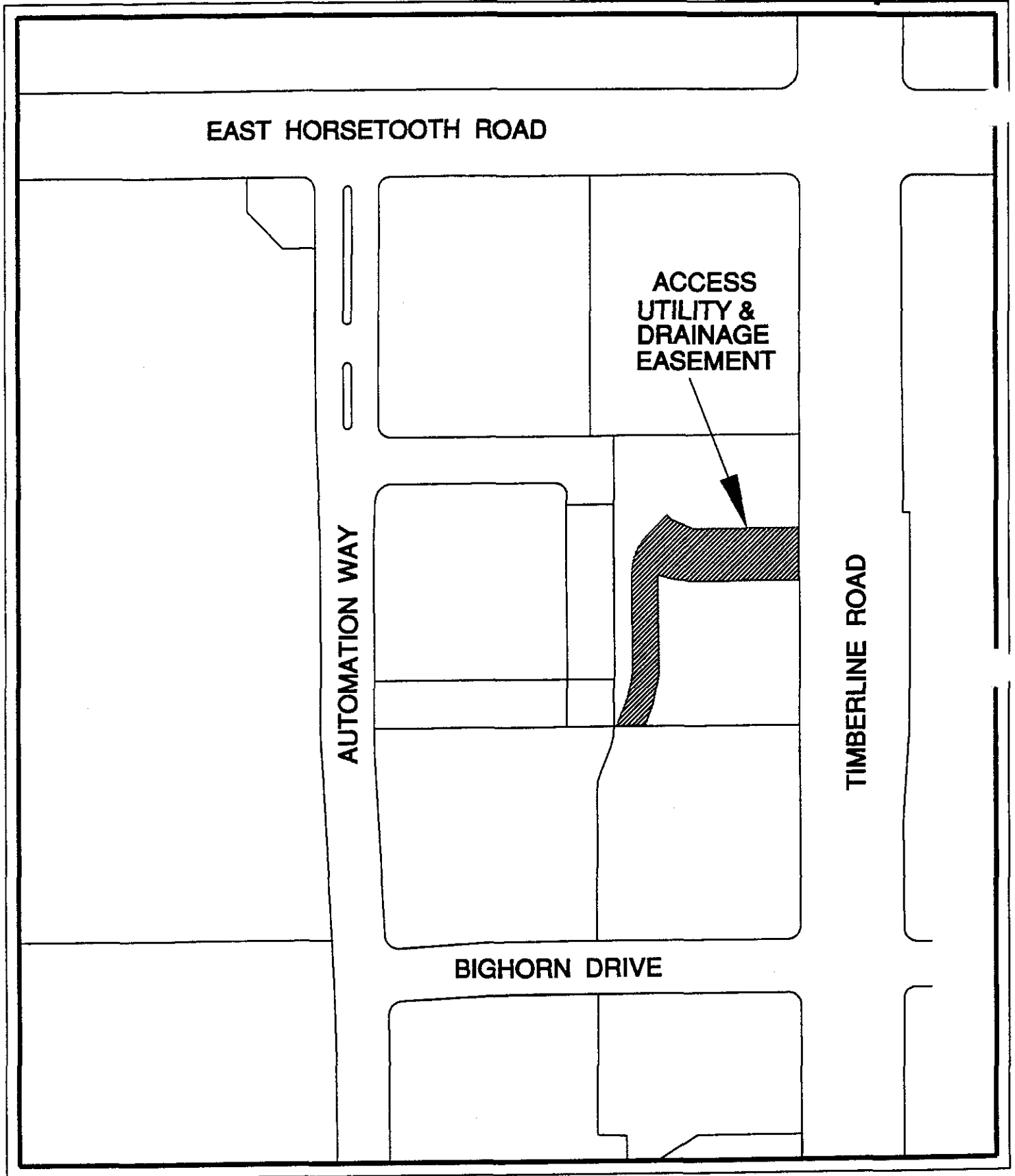

VICINITY MAP
Proposed Access,
Utility & Drainage Easement

04/12/99
NTS



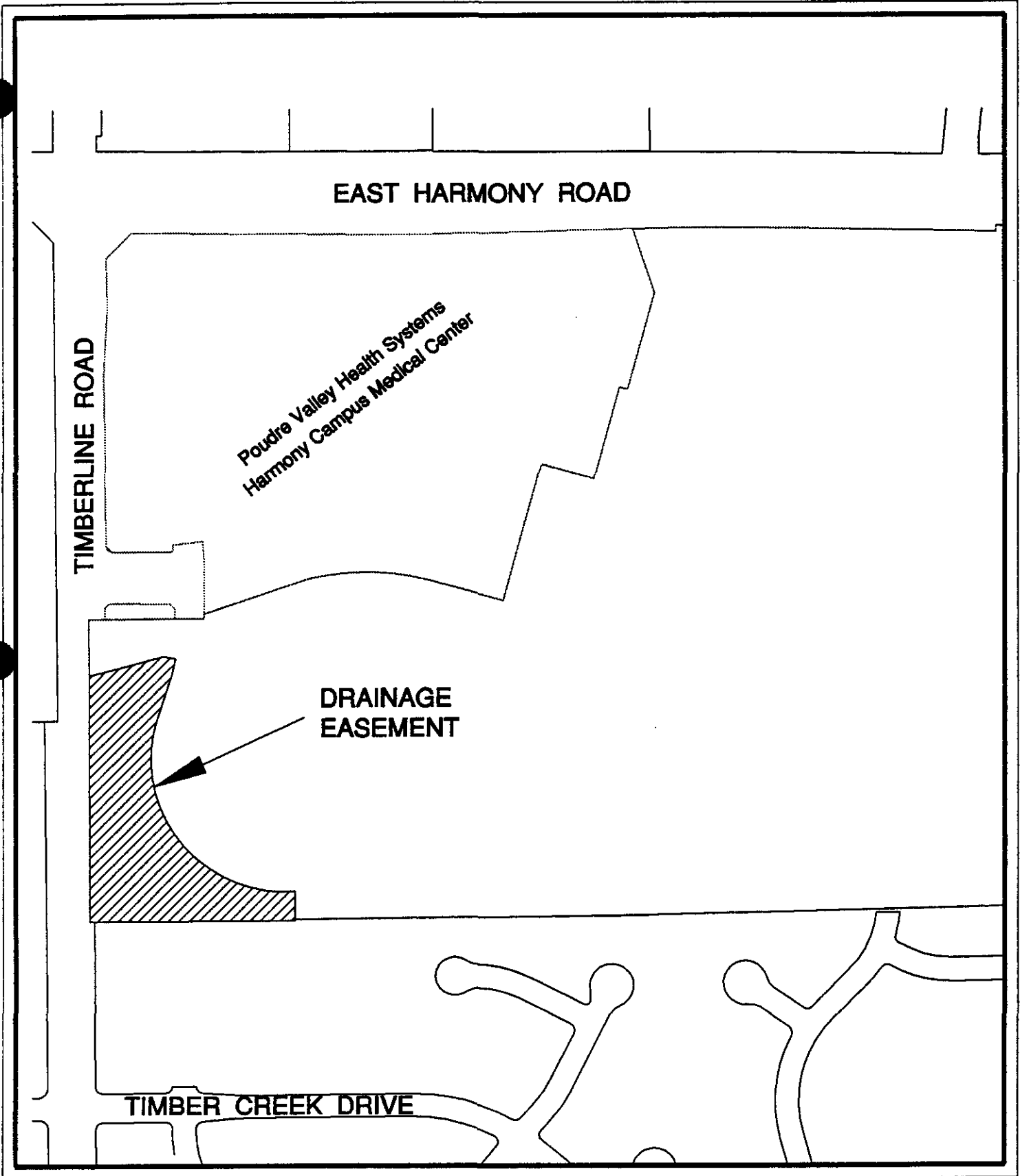

VICINITY MAP
Proposed
Drainage Easement

04/21/99
NTS



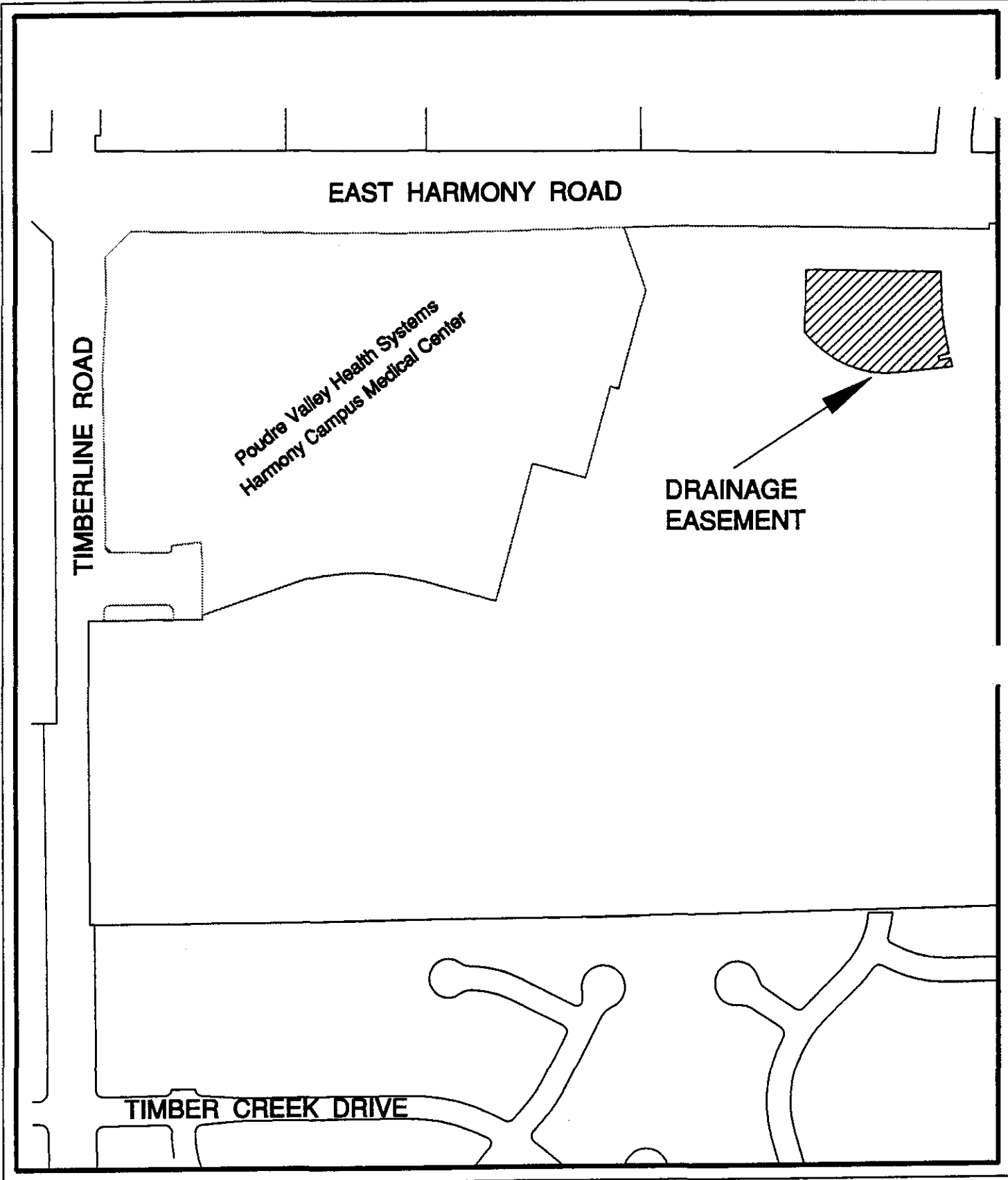

VICINITY MAP
Proposed
Drainage Easement

04/21/99
NTS



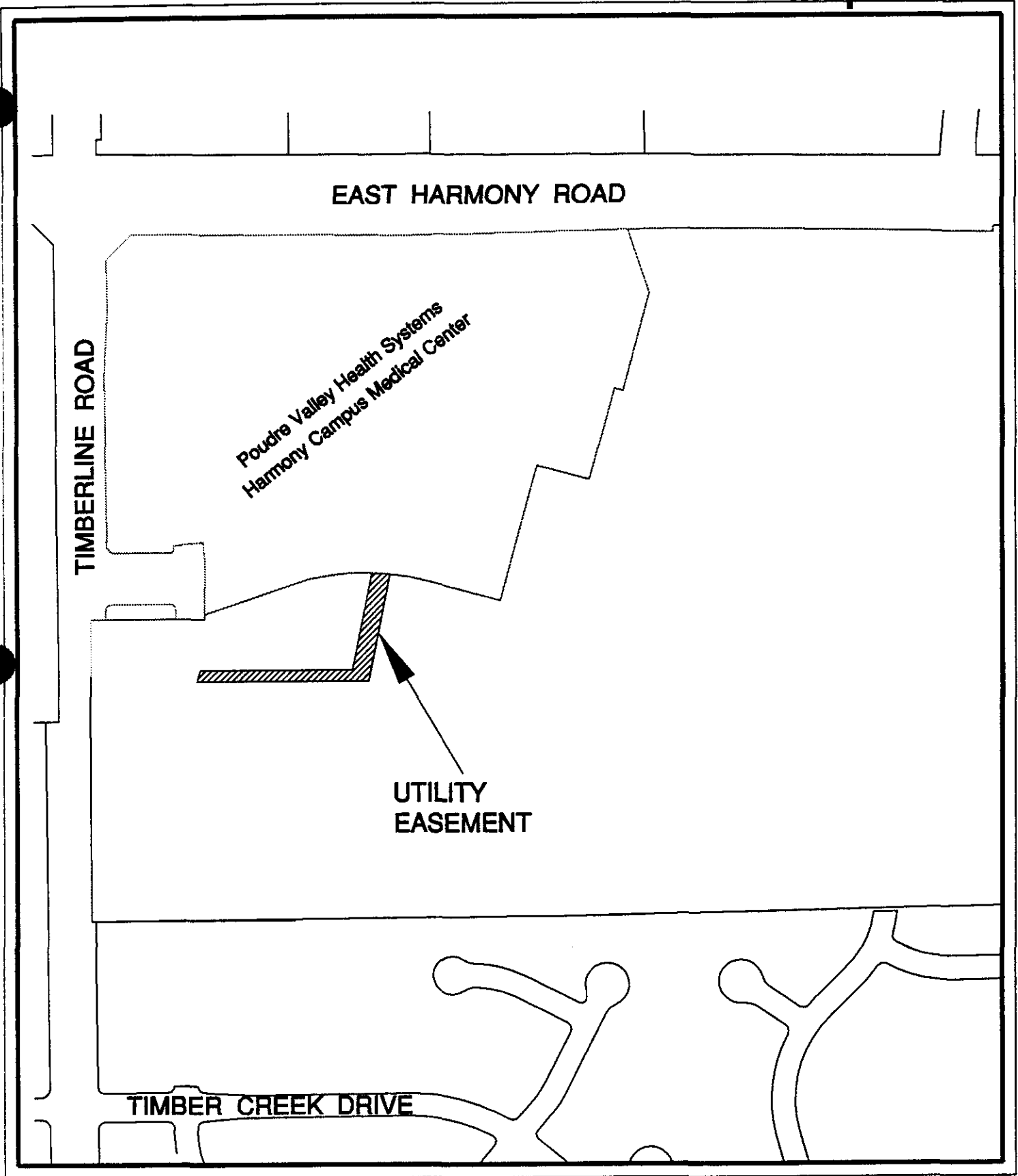

VICINITY MAP
Proposed
Utility Easement

04/21/99
NTS



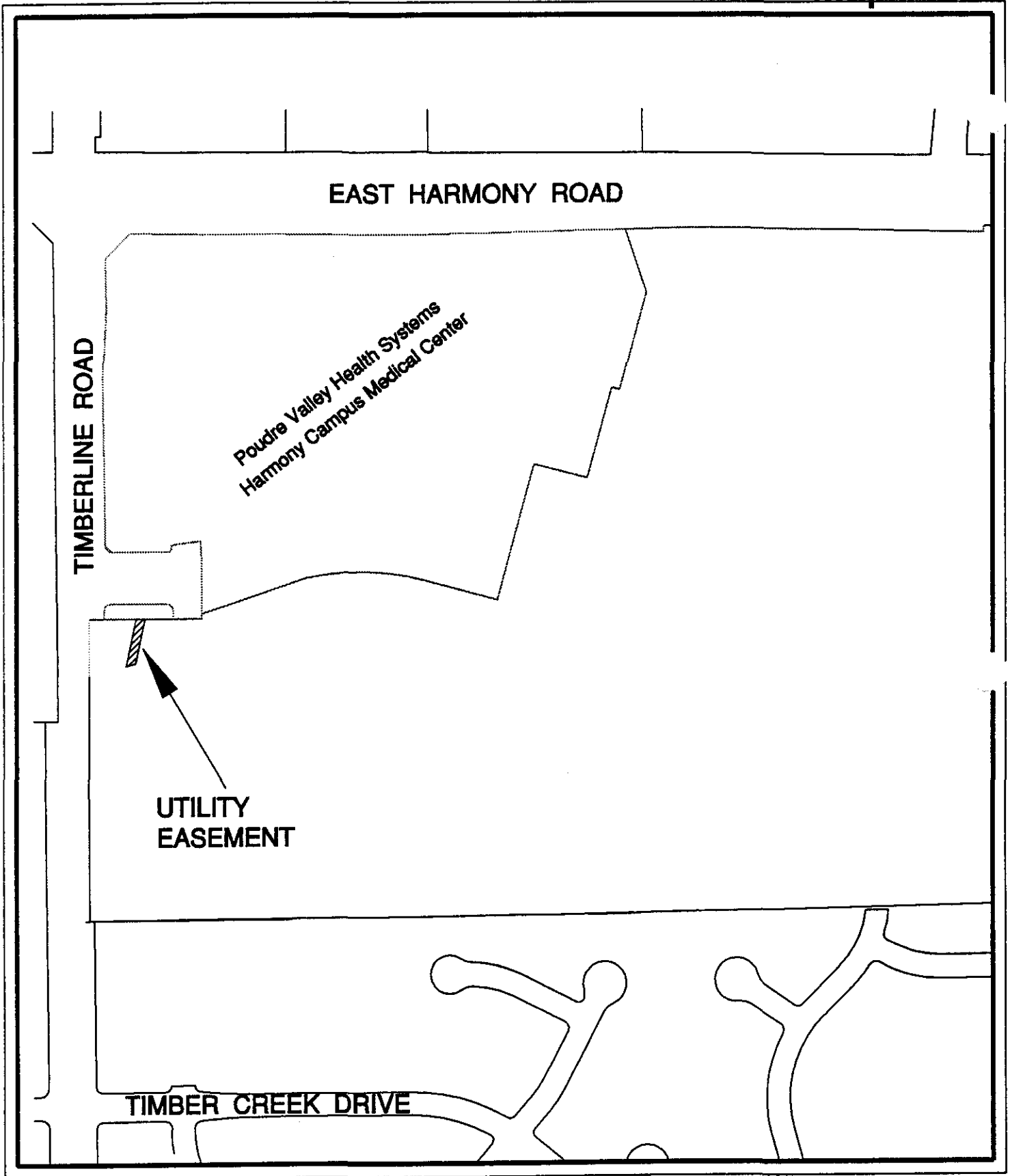

VICINITY MAP
Proposed
Utility Easement

04/21/99
NTS



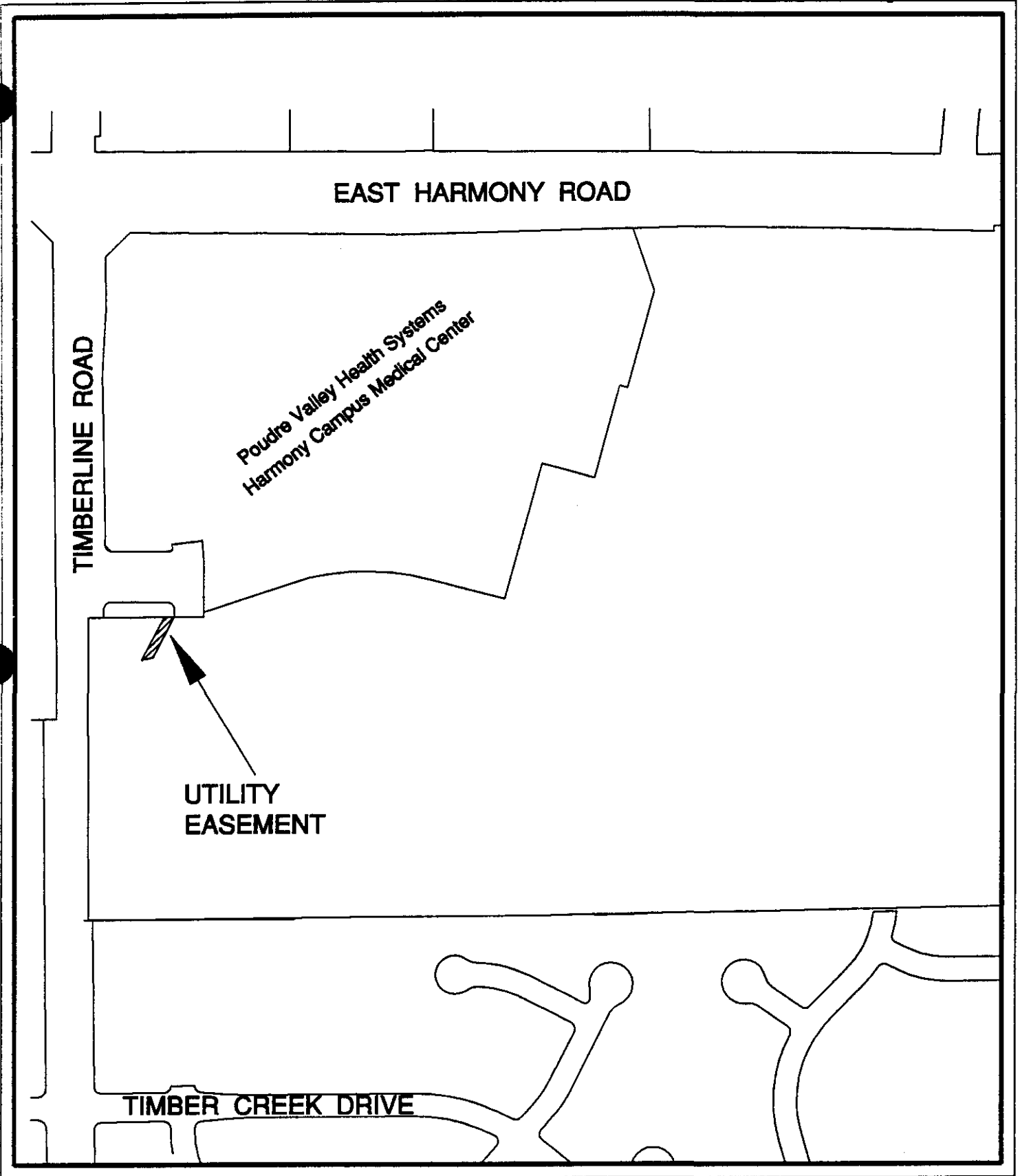

VICINITY MAP
Proposed
Utility Easement

04/21/99
NTS



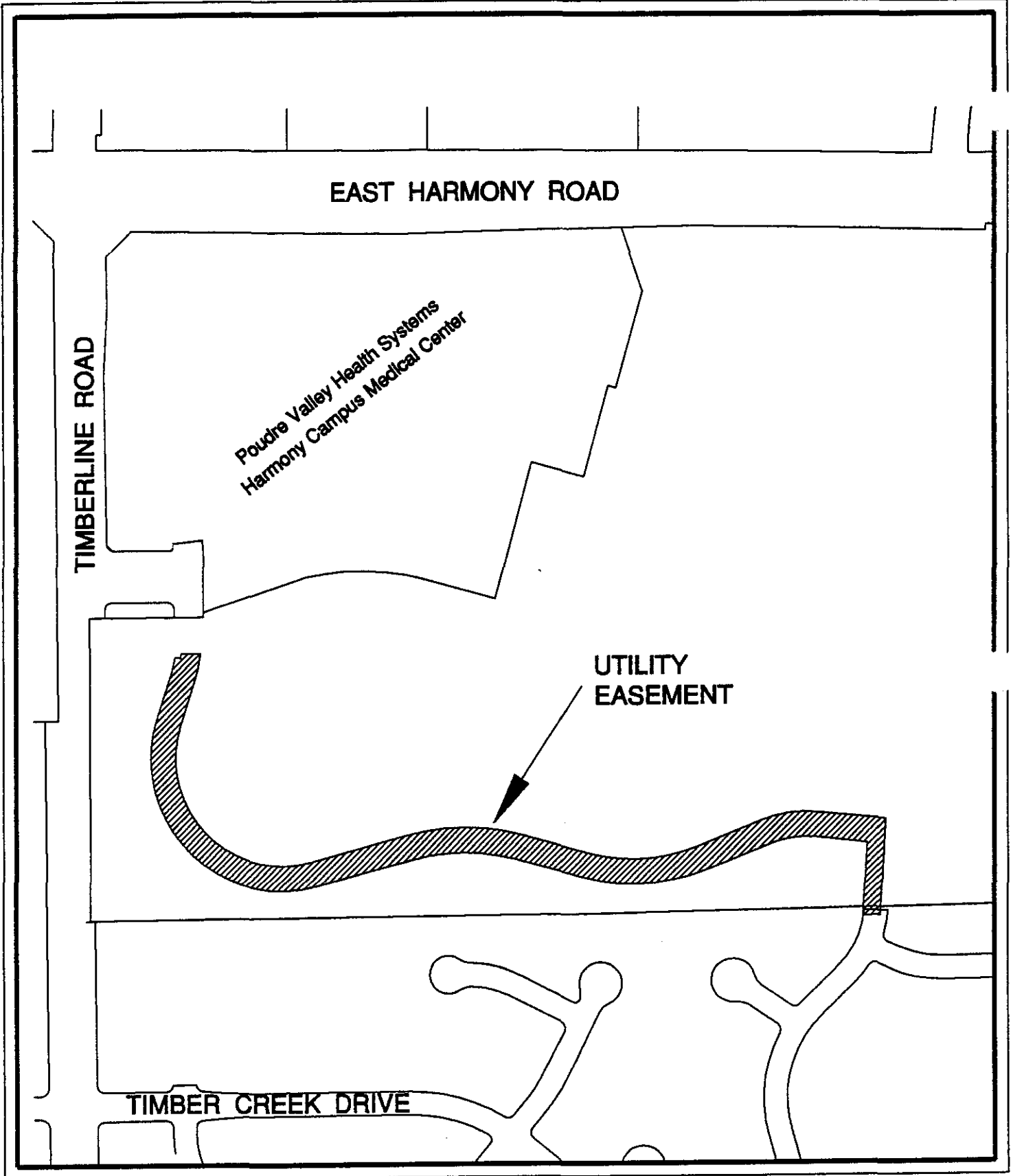

VICINITY MAP
Proposed
Utility Easement

04/21/99
NTS



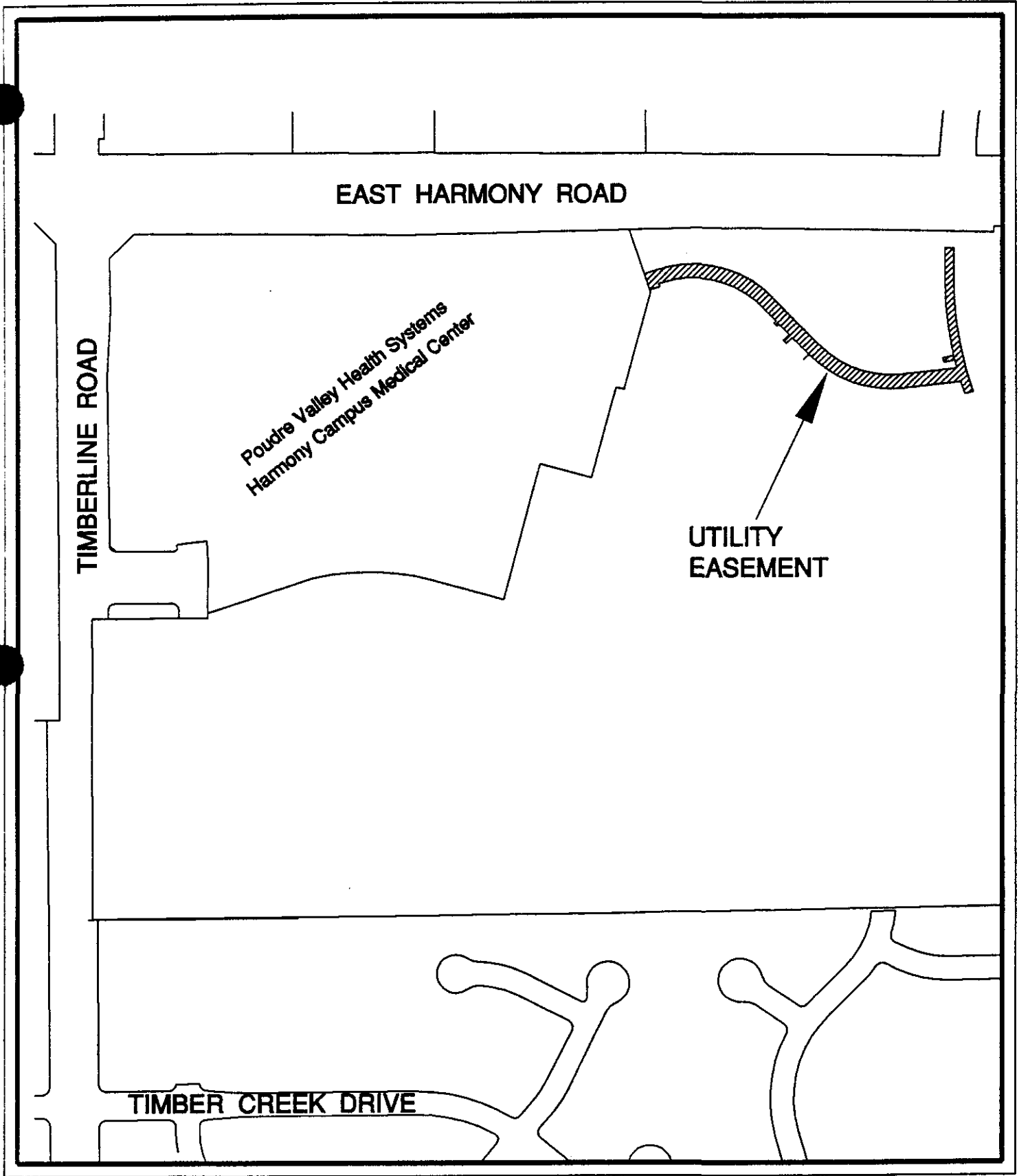

VICINITY MAP
Proposed
Utility Easement

04/21/99
NTS



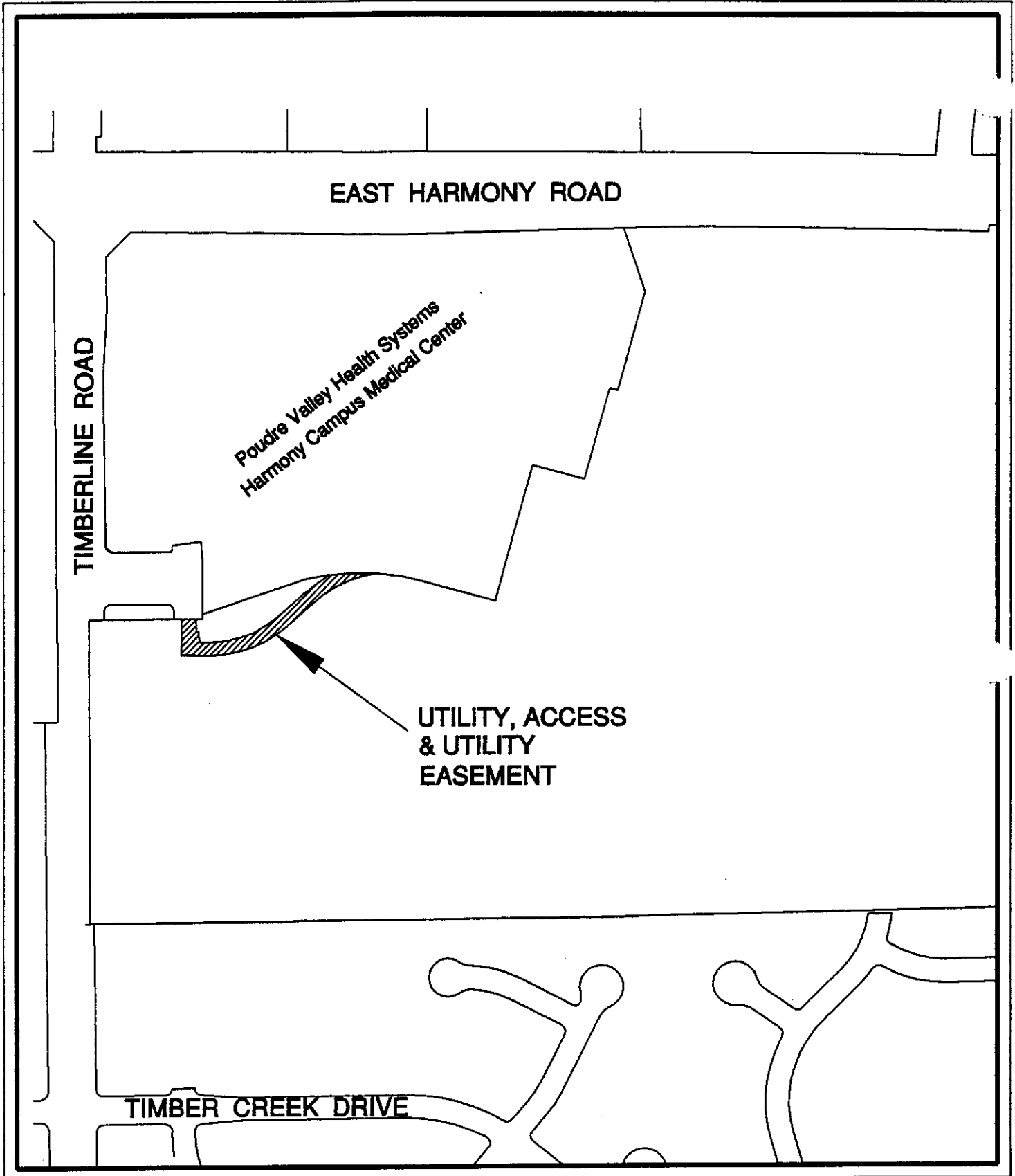

VICINITY MAP
Proposed Utility,
Access & Drainage Easement

04/21/99
NTS



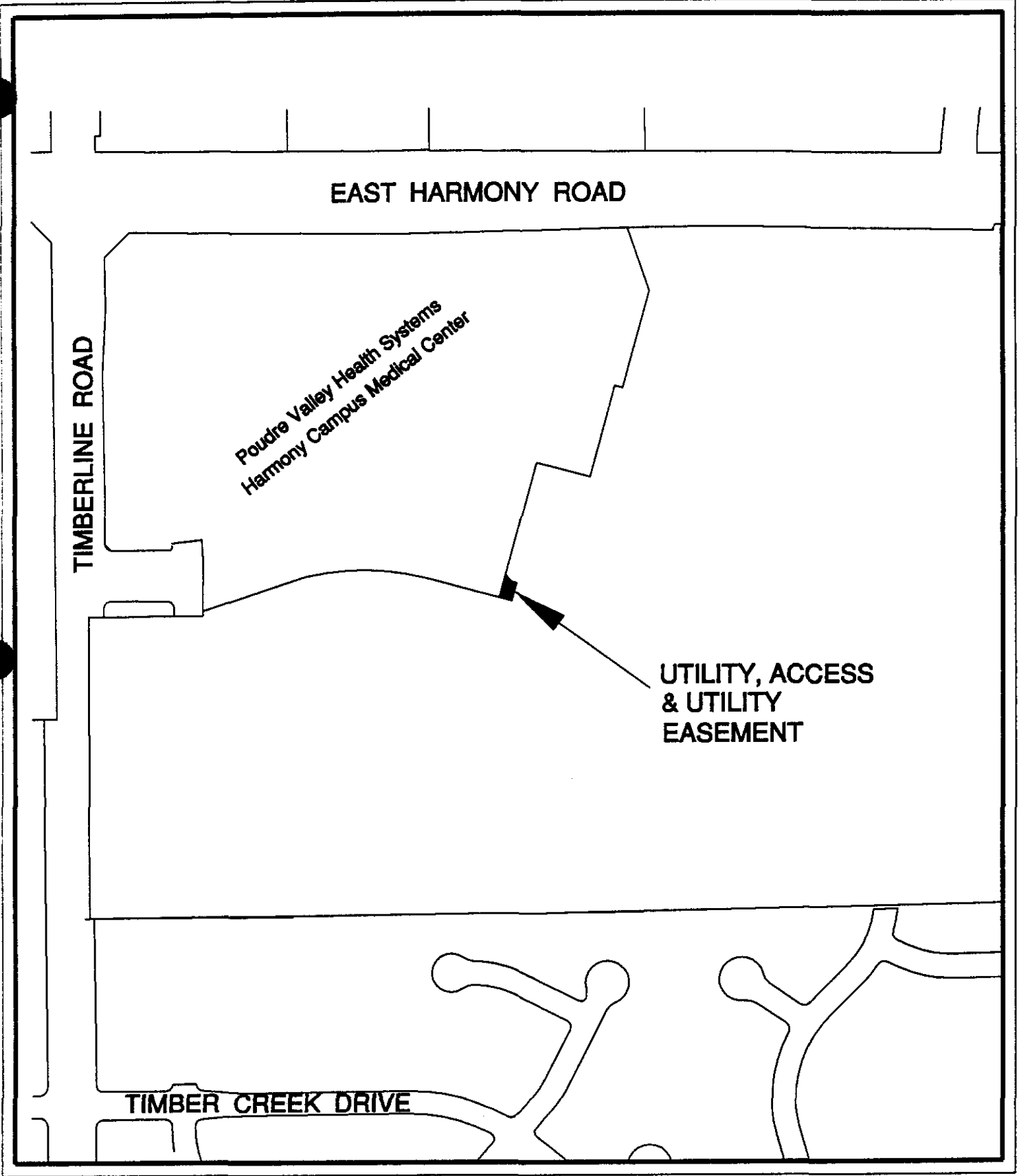

VICINITY MAP
Proposed Utility,
Access & Drainage Easement

04/21/99
NTS



EAST HARMONY ROAD

TIMBERLINE ROAD

Poudre Valley Health Systems
Harmony Campus Medical Center

DRAINAGE
EASEMENT

TIMBER CREEK DRIVE

VICINITY MAP

Proposed
Drainage Easement

04/21/99
NTS



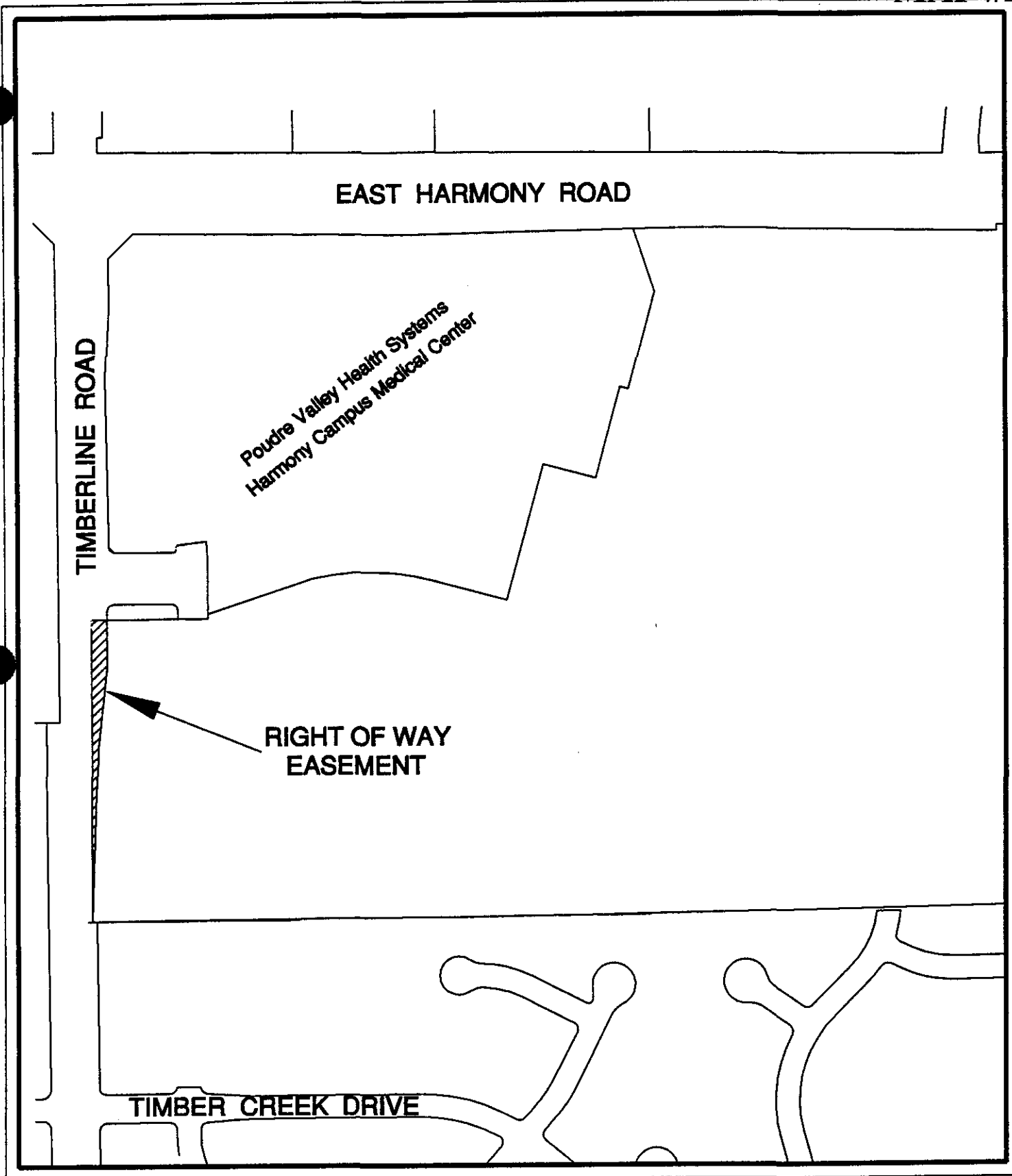

VICINITY MAP
Proposed
Right Of Way Easement

04/21/99
NTS

