

x:\39330000\all\39334600\dwg\contract\1\1 SITE PLAN\BLDG.H.dwg, DC, 03/19/2004, 02:42:10 PM, fontanel

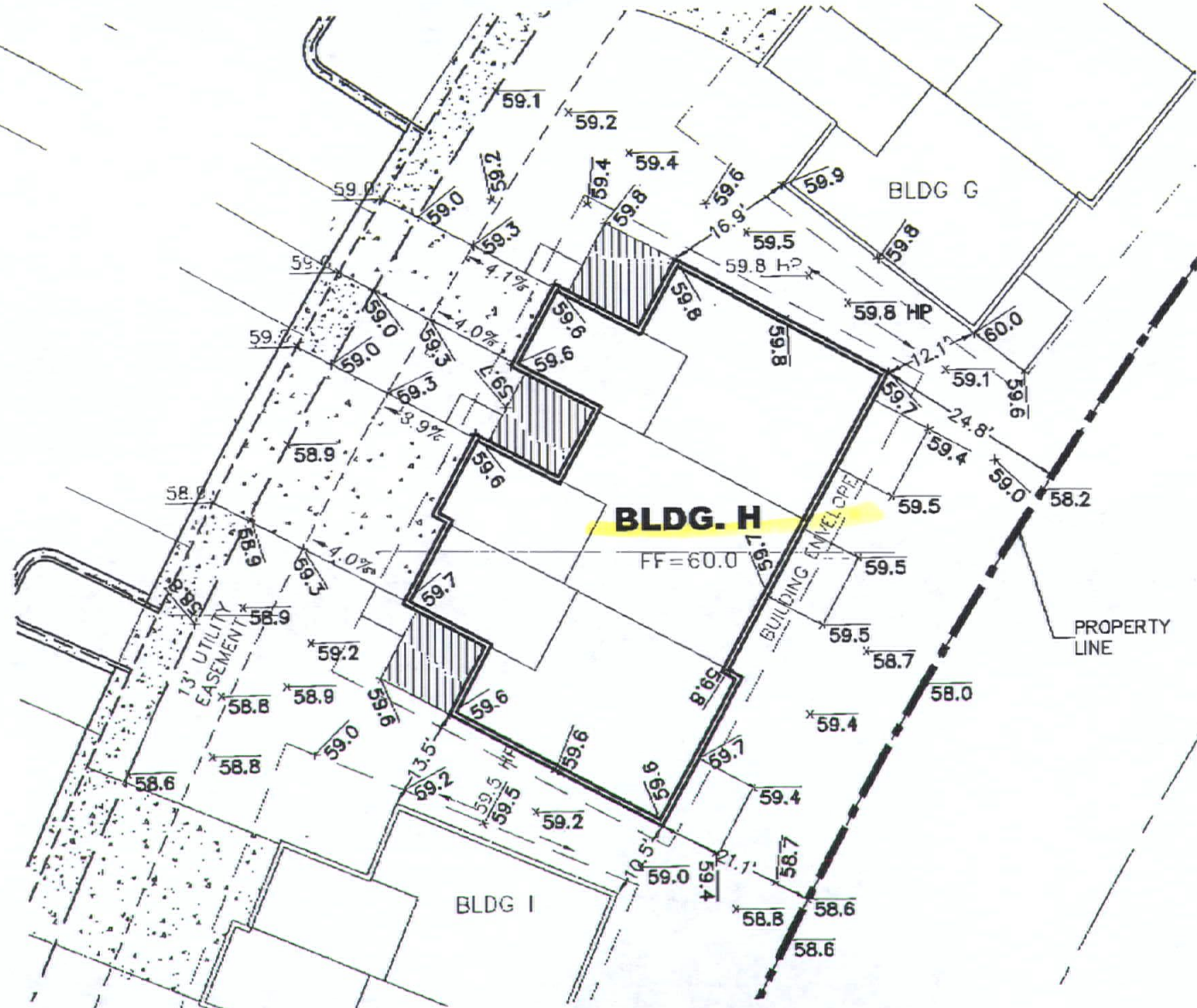

3-26-04



SCALE 1" = 20'

J-R ENGINEERING
A Subsidiary of Westrian

2620 East Prospect Road • Ft. Collins, CO 80525
(970)-491-9888 • Fax: (970)491-9984 • www.jrengineering.com

**DRAINAGE CERTIFICATION
FISBECK & SHEEL**

LEGAL DESCRIPTION: 721 WATERGLEN DRIVE
LOT: BLOCK:
MODEL: BUILDING H
ADDRESS: 721 WATERGLEN DRIVE
TOWN: FORT COLLINS COUNTY: LARIMER
STATE: COLORADO

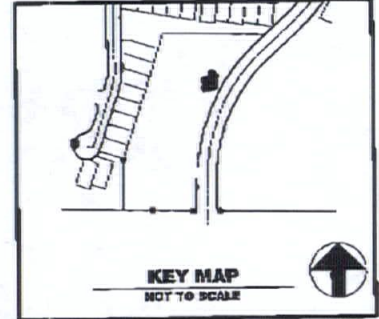

THE ATTACHED DRAWING SHOWS THE ELEVATIONS AND DRAINAGE PATTERNS THAT ARE THE REGISTERED PROFESSIONAL ENGINEER'S CERTIFIED FINDINGS OF THE FINISHED GROUND GRADES FOR THE ABOVE DESCRIBED PROPERTY AND ARE IN GENERAL CONFORMANCE TO THE APPROVED DRAINAGE AND GRADING PLAN EXCEPT AS NOTED. THE ELEVATIONS AS DEPICTED HEREON MAY CHANGE SUBJECT TO THE DATE OF THE SURVEY DUE TO NATURAL AND/OR ARTIFICIAL ACTIONS.

JAMES W. WRIGHT P.E. #34809
FOR AND ON BEHALF OF JR ENGINEERING, LLC

3/19/04
DATE

INFORMATION REQUIRED ON:

TOP OF FOUNDATION: N/A
FINISHED FLOOR: 59.9
WINDOW WELL: N/A
TOP OF SLAB: 59.6

No.	REVISION	BY	DATE

ABERDEEN AT WATERGLEN P.U.D.

PROJECT #: 39334.02 DRAWN BY: TJF DATE: 03.18.04

Intermed 3/30/04