

9-30-02  
*[Signature]*

September 24, 2002



TO WHOM IT MAY CONCERN:

802 Waterglen DR

THE PROPERTY DESCRIBED LYING WITHIN TRACT P-1, WATERGLEN P.U.D., COUNTY OF LARIMER, STATE OF COLORADO (PER CLIENT) MULTIFAMILY BUILDINGS D, E, AND F.

DRAINAGE CERTIFICATE:

THE ATTACHED DRAWING SHOWS THE ELEVATIONS AND DRAINAGE PATTERNS THAT ARE THE REGISTERED PROFESSIONAL ENGINEERS CERTIFIED FINDINGS OF THE FINISHED GROUND GRADES FOR THE ABOVE DESCRIBED PROPERTY AND ARE IN GENERAL CONFORMANCE TO THE APPROVED DRAINAGE AND GRADING PLAN UNLESS OTHERWISE NOTED. THE ELEVATIONS AS DEPICTED HEREON MAY CHANGE SUBSEQUENT TO THE DATE OF THE SURVEY DUE TO NATURAL AND/OR ARTIFICIAL ACTIONS.



KYLE D. AREND, P.E.  
FOR AND ON BEHALF OF J-R ENGINEERING, LLC

9/23/02  
DATE OF SURVEY

STORMWATER RECEIVED

SEP 25 2002

*Checked 10/11/02*

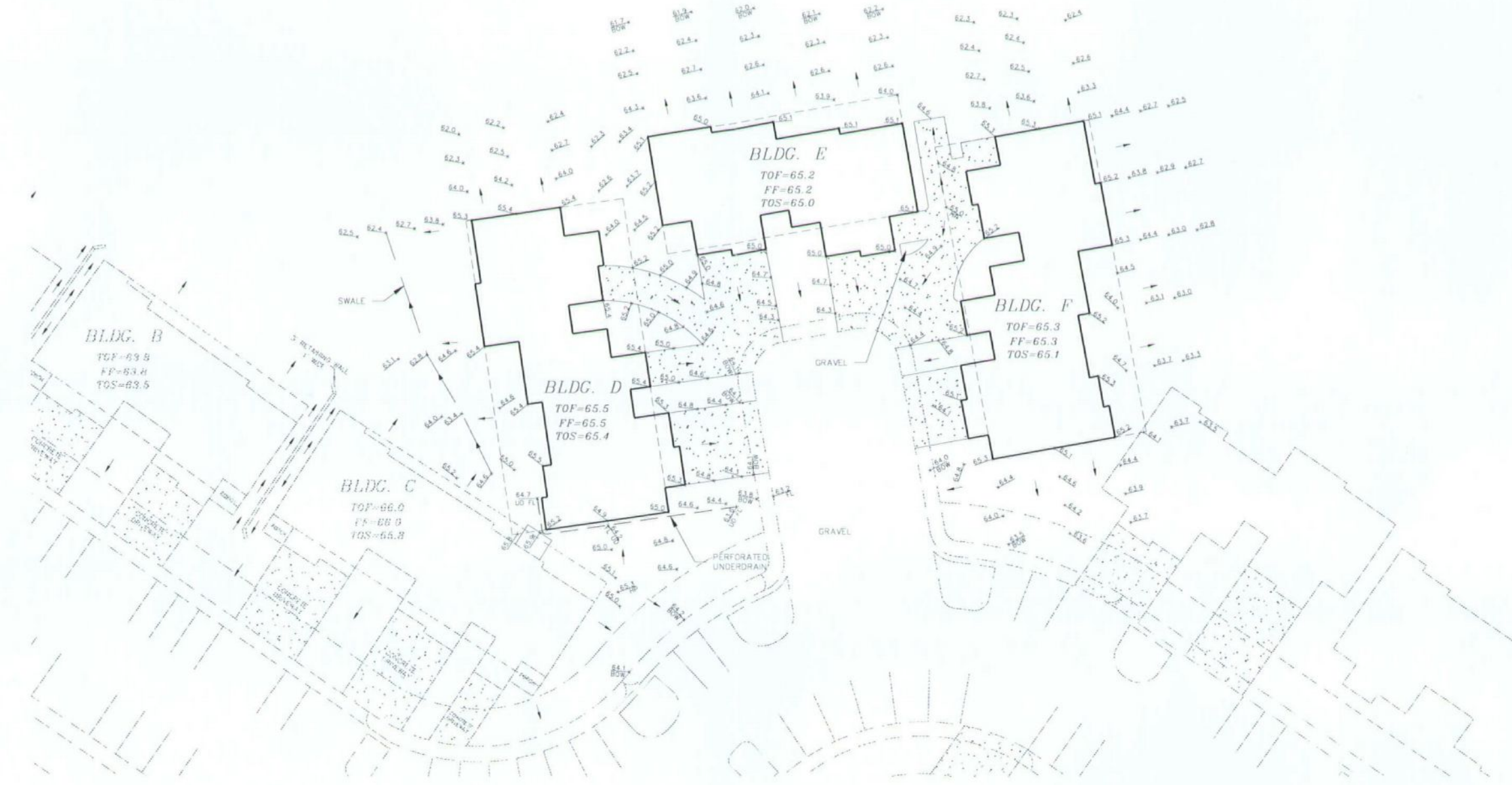

**LEGEND**

- 105 NUMBER OF STANDARD PARKING SPACES
- HANDICAPPED PARKING SPACE
- B BIKE PARKING
- T TRASH ENCLOSURE
- R HANDICAPPED ACCESS RAMP
- ID IDENTITY SIGN

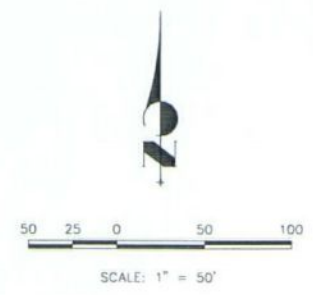

**LAND USE SUMMARY**

TRACT P1 (MULTI-FAMILY)  
 GROSS AREA = 251,990 S.F.  
 DWELLING UNITS TOTAL = 66  
 COVERAGE:  
 BUILDINGS = 53,135 S.F.  
 PARKING AND DRIVES = 82,319 S.F.  
 OPEN SPACE = 114,536 S.F.

TRACT P2 (DRAINAGE EASEMENT)  
 GROSS AREA = 168,424 S.F.

**VITAL STATISTICS**

100 UNITS  
 15 ACCESSIBLE UNITS (AC)  
 100 DRIVEWAY PARKING SPACES  
 90 STREET PARKING SPACES  
 150 TOTAL PARKING SPACES

UNTIL SUCH TIME AS THESE DRAWINGS ARE APPROVED BY THE APPROPRIATE REVIEWING AGENCIES, JR ENGINEERING APPROVES THEIR USE FOR THE PURPOSES DESIGNATED BY WRITTEN AUTHORIZATION.

PREPARED FOR

**JR ENGINEERING**  
 A Subsidiary of Watston



2620 E. Prosser Rd. Ste. 101-Ft. Collins, CO 80525  
 970-497-9888 • Fax 970-497-9884  
 www.jrengineering.com

NO.	REVISION	BY	DATE
1.	INSERTED SPOT ELEVATIONS FOR DC	MPD	09/24/02

**WATERGLEN P.U.D.**  
**MULTI-FAMILY & VILLAGE CENTER**  
 DRAINAGE CERTIFICATION  
 (SEE ATTACHED LETTER  
 FOR CERTIFICATION)