

GRADING & DRAINAGE PLAN

SCALE: 1" = 20'-0"

BP #s B1004709 - house

B1004710 - garage

Released 8-4-10 WL

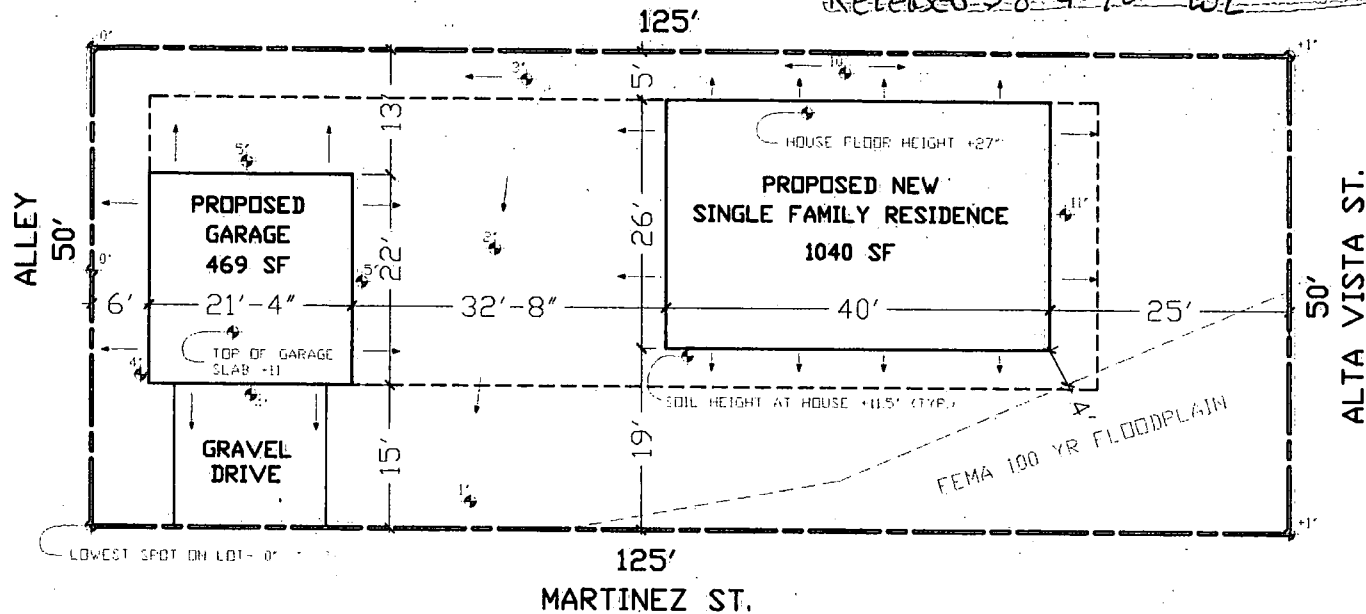

NOTES:

THIS PROPERTY IS PARTIALLY LOCATED IN THE 100 YR FEMA-REGULATORY FLOODPLAIN FOR DRY CREEK. THE ENTIRE PROPERTY IS LOCATED IN THE 500 YR FEMA-REGULATORY FLOODPLAIN FOR THE CACHE LA POUDE RIVER. ALL ACTIVITIES ON THIS PROPERTY ARE SUBJECT TO THE REQUIREMENTS OF CHAPTER 10 OF THE CITY CODE.

NO CRITICAL FACILITY MAY BE ESTABLISHED BY NEW CONSTRUCTION OR CHANGE OF USE ON THIS PROPERTY WITHIN ANY FEMA REGULATORY FLOODPLAIN.

<p>SINGLE FAMILY RESIDENCE 3 BED/ 1 BATH 1040 SF</p>	<p>PROPERTY ADDRESS: 727 ALTA VISTA ST. FORT COLLINS, CO 80524</p>	<p>OWNER CONTACT INFORMATION</p>	<p>JULY 2010</p>
<p><i>Lot 6 - Alta Vista</i></p>			