

# WEST VINE STORAGE FORT COLLINS, CO PROJECT DEVELOPMENT PLAN

### LIGHT FIXTURE SCHEDULE

- A FIXTURE - WALL MOUNTED AT 8'-0" AFF  
LSI - XWM - FT - 30 - LED
- B FIXTURE - WALL MOUNTED AT 13'-0" AFF  
LSI - XWM - FT - 30 - LED
- C FIXTURE - WALL MOUNTED AT 10'-0" AFF  
LSI - XWM - FT - 30 - LED
- D FIXTURE - WALL MOUNTED AT 8'-0" AFF  
LSI - XWM - FT - 30 - LED

SYMBOL	QUANTITY	LABEL	DESCRIPTION	LLF	LUMENS	WATTAGE	DEGREES 'K'
□	31	A	XWM-FT-30-LED-06-30-8" MH	0.90	5635	54	3000
□	14	B	XWM-FT-30-LED-06-30-13" MH	0.90	5635	54	3000
□	6	C	XWM-FT-30-LED-06-30-10" MH	0.90	5635	54	3000
□	2	D	XWM-FT-30-LED-06-30-8" MH	0.90	5635	54	3000

CALCULATION SUMMARY						
LABEL	CALC TYPE	UNITS	AVG.	MAX.	MIN.	
ALL POINTS AT GRADE	ILLUMINANCE	Fc	1.20	11.2	0.0	
INSIDE PARKING AREA - 1	ILLUMINANCE	Fc	3.19	11.2	0.0	

**HABITAT NOTE**  
THE NATURAL HABITAT BUFFER ZONE IS INTENDED TO BE MAINTAINED BY A NATIVE LANDSCAPE. PLEASE SEE SECTION 3.4.1 OF THE LAND USE CODE FOR ALLOWABLE USES WITHIN THE NATURAL HABITAT BUFFER ZONE.

**NATURAL HABITAT BUFFER ZONE**  
EXTENDS FROM THE NORTH PROPERTY LINE TO THE SOUTH LINE OF THE DRAINAGE EASEMENT

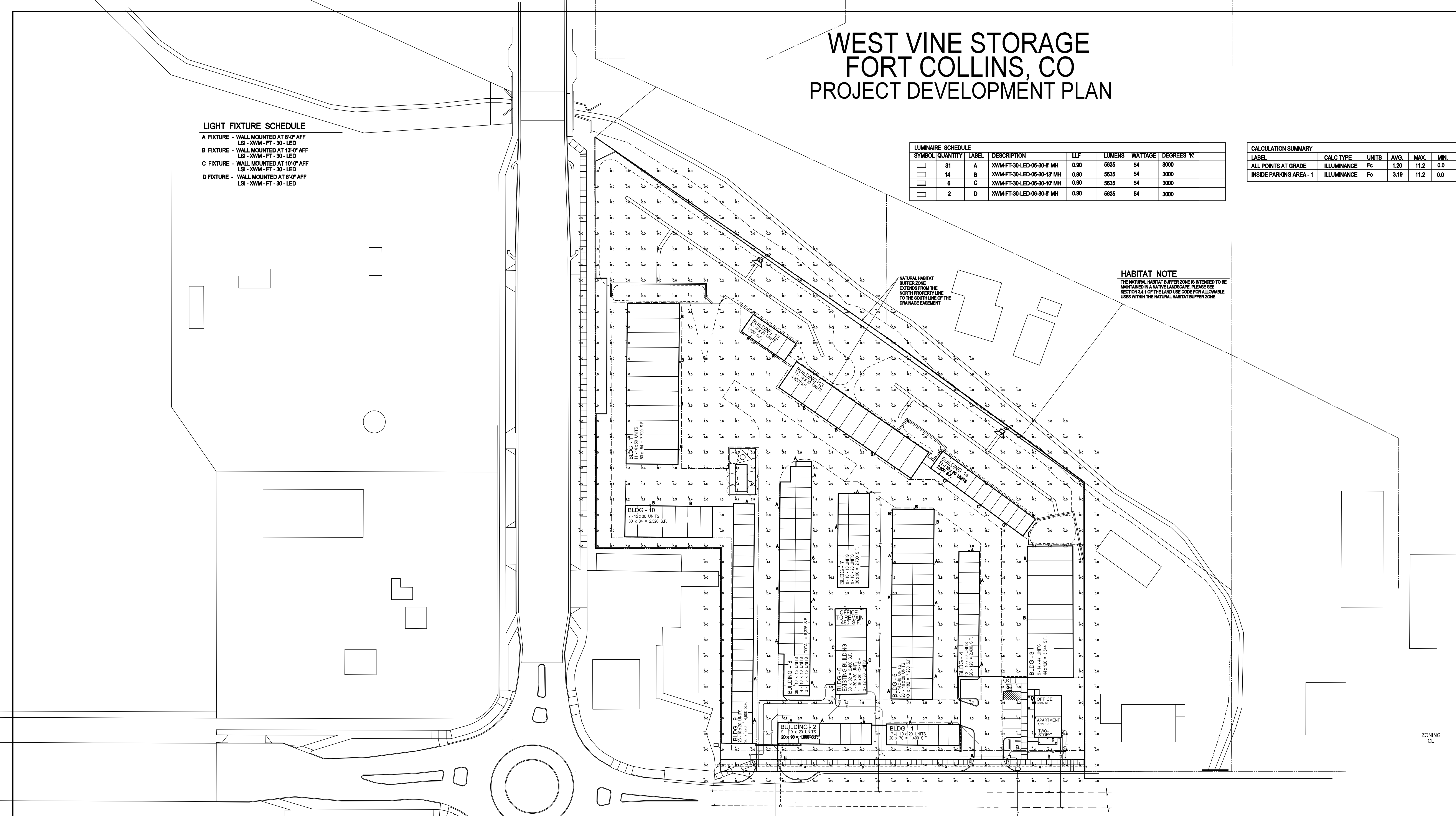

## PHOTOMETRIC PLAN

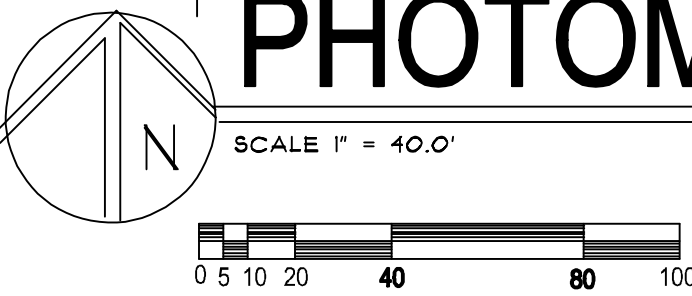

### PHOTOMETRIC PLAN

WEST VINE STORAGE  
FORT COLLINS, COLORADO  
HATTMAN ASSOCIATES  
ARCHITECTURE & PLANNING  
524 S. LOOMS AVE.  
FORT COLLINS, COLORADO 80521  
970.218.4453

DATE: 8/17/17  
REV: 2/20/18  
REV:

**SP - 4.1**