

CITY OF FORT COLLINS PUBLIC WORKS DEPARTMENT
POST CONSTRUCTION ELEVATION CERTIFICATE/FLOOD-PROOFING CERTIFICATE

28322

PROPERTY ADDRESS: 732 MARTINEZ ST., FORT COLLINS, COLORADO 80524

TYPE OF USE (COMMERCIAL OR RESIDENTIAL): RESIDENTIAL

DATE CONSTRUCTION COMPLETED: FOUNDATION COMPLETED JAN. 25, 1988

NAME OF FLOODPLAIN BUILDING IS LOCATED IN: DRY CREEK
(Spring Creek, Dry Creek or Poudre River)

BASE FLOOD ELEVATION AT THE SITE: 4951.0

NAME, ADDRESS, PHONE OF OWNER: NEIGHBOR TO NEIGHBOR INC.

429 PINE ST., FT COLLINS, CO 80524 484-7498

INSTRUCTIONS

Complete only the Elevation Certification unless the building has been flood-proofed at least to the base flood elevation. If flood-proofing has been used, complete only the Flood-Proofing Certification. The Elevation Certification may be completed by a registered professional engineer, architect, or surveyor. The Flood-Proofing Certification may only be completed by a registered professional engineer or architect.

ELEVATION CERTIFICATION

I certify that the building at the property location described above has the lowest floor (including basement) at an elevation of:

4952.54 feet NGVD (Mean Sea Level)

FLOOD-PROOFING CERTIFICATION

I certify to the best of my knowledge, and belief, that the structure at the property location described above is designed with walls substantially impermeable to the passage of water and contains structural components having the capability of resisting hydrostatic and hydrodynamic loads and effects of buoyancy that would be caused by the flood depth, pressures, velocities, impact and uplift forces associated with the base flood and that the structure is water-tight to an elevation of:

_____ feet NGVD (Mean Sea Level)

In the event of flooding, will this degree of flood-proofing be achieved with human intervention? _____

CERTIFIER'S NAME: RICHARD A. RUTHERFORD

Affix Seal or Write
Professional License
Number Below:

TITLE: P.E. & L.S.

ADDRESS: P.O. Box 429, Ft COLLINS, CO 80522

Richard A. Rutherford 2/10/88
(Signature) (Date)



cc: Owner
Building Inspection

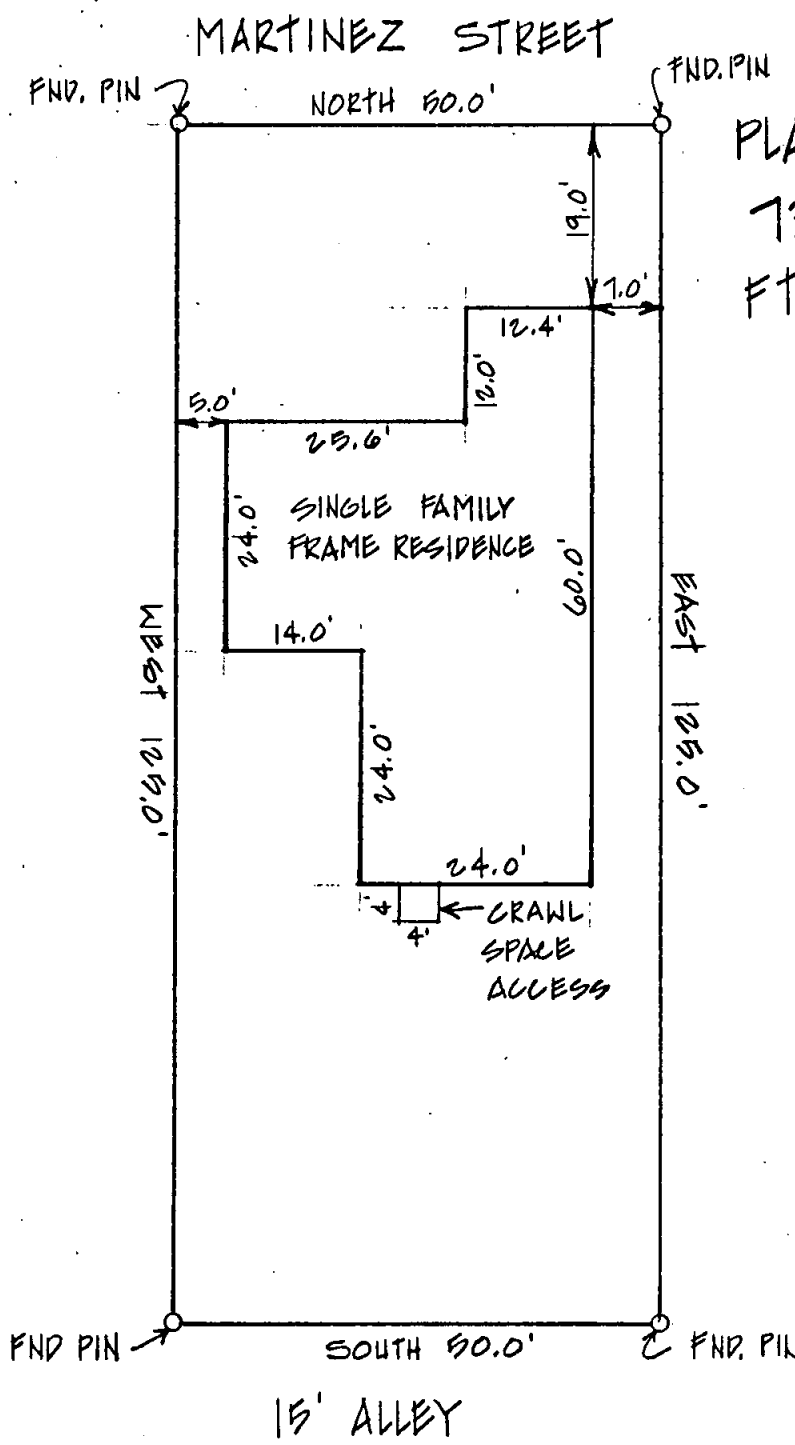

PLAT OF A SURVEY OF
732 MARTINEZ ST.
FT. COLLINS, CO.

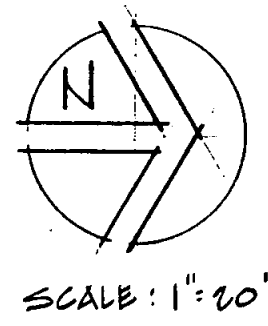

CERTIFICATE

This is to certify that on the 27th day of January, A.D. 1988, a survey was made under my supervision of 732 Martinez Street, which is Lot 16, Alta Vista Subdivision, City of Fort Collins, County of Larimer, State of Colorado, and the one story frame residence was found to be entirely within the boundary lines as shown on this plat. The locations and dimensions of all buildings, improvements, easements and rights-of-way in evidence or known to me and encroachments by or on the premises are accurately shown.

Richard A. Rutherford



CITY OF FORT COLLINS

Office of Community Development, Planning Division

LETTER OF TRANSMITTAL

TO: Building Department
732 Mountain Blvd
Fort Collins, CO 80524

DATE: 2/29/88
PROJECT: 732 Mountain Blvd
10' x 10' Utility Easement

TRANSMITTED HERE WITH ARE:

REDLINED UTILITY PLANS TO BE RETURNED WITH REVISIONS BY _____

DEVELOPMENT AGREEMENT

Please sign, seal, date and return all copies of this agreement no later than Noon, _____ . Returning it later than the abovementioned time will place the project on the following month's agenda. Changes in the agreement take two (2) days to process if they are acceptable. Please take this into account in your schedule.

Again, all copies must be returned if all parties are to receive a copy with original signatures.

ORIGINAL MYLARS NEEDING REVISIONS

Please return with yellow tabs intact by _____

ORIGINAL MYLARS WITH CITY SIGNATURES

Please return one mylar and three (3) blue-line print copies for our files by _____

SUBDIVISION TAKE-OFF

According to our Utility Drawing Submittal Procedure, we should now be in receipt of the Quantity Take-off for this project. Would you please complete this and submit it as soon as possible.

OTHER: Per the structure's elevation certificate, I need to have
certificates. Therefore all elevations must be
checked and submitted to the City of Fort Collins

BY Steve Smith - 5/1/88