

CDOT PARK & Ride Facility

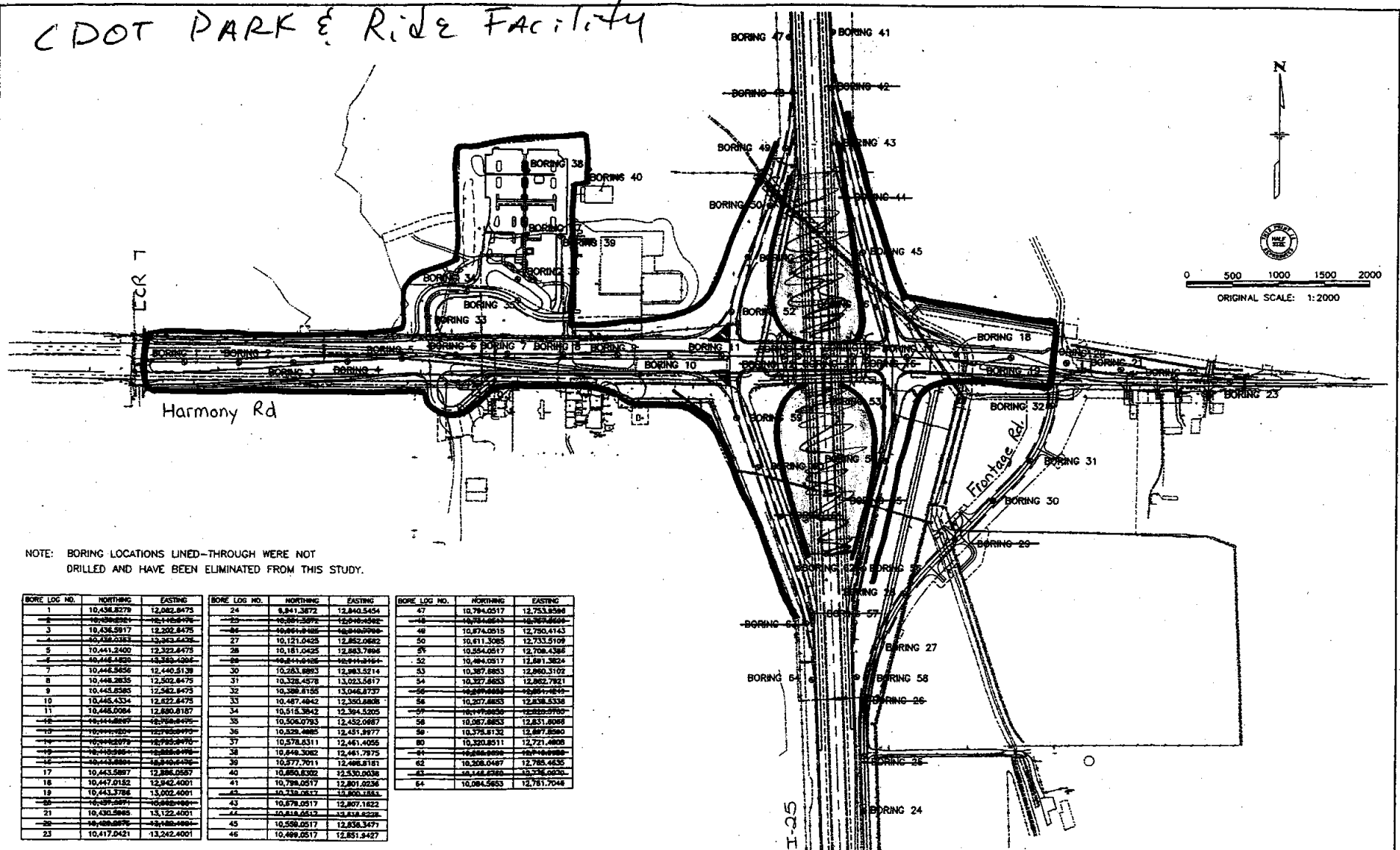

NOTE: BORING LOCATIONS LINED-THROUGH WERE NOT DRILLED AND HAVE BEEN ELIMINATED FROM THIS STUDY.

BORE LOG NO.	NORTHING	EASTING	BORE LOG NO.	NORTHING	EASTING	BORE LOG NO.	NORTHING	EASTING
1	10,436.8279	12,042.6475	24	10,841.2872	12,845.4554	47	10,794.0517	12,753.9586
2	10,436.8279	12,042.6475	25	10,841.2872	12,845.4554	48	10,874.0515	12,750.4143
3	10,436.8279	12,042.6475	26	10,841.2872	12,845.4554	49	10,874.0515	12,750.4143
4	10,436.8279	12,042.6475	27	10,121.0425	12,852.0622	50	10,611.3065	12,733.5109
5	10,441.2400	12,322.6475	28	10,181.0425	12,863.7896	51	10,554.0517	12,708.4366
6	10,446.4830	13,389.4065	29	10,841.2872	12,845.4554	52	10,484.0517	12,691.3824
7	10,446.4830	12,440.5139	30	10,783.8993	12,983.5214	53	10,387.8853	12,860.5102
8	10,446.4830	12,502.6475	31	10,328.4578	13,023.5817	54	10,327.8853	12,860.7821
9	10,445.8585	12,542.6475	32	10,388.8155	13,046.8727	55	10,327.8853	12,860.7821
10	10,445.8585	12,822.6475	33	10,487.4842	12,350.8808	56	10,207.8853	12,828.5338
11	10,445.8585	12,890.8187	34	10,518.3842	12,394.5205	57	10,197.8853	12,828.5338
12	10,445.8585	12,958.8475	35	10,506.0793	12,452.0687	58	10,087.8853	12,831.8058
13	10,445.8585	12,958.8475	36	10,529.4885	12,451.8977	59	10,578.8132	12,687.8580
14	10,445.8585	12,958.8475	37	10,578.8311	12,461.4055	60	10,320.8511	12,721.8808
15	10,445.8585	12,958.8475	38	10,648.3082	12,461.7975	61	10,648.3082	12,461.7975
16	10,445.8585	12,958.8475	39	10,577.7011	12,498.8181	62	10,528.0497	12,785.4835
17	10,443.5887	12,896.0587	40	10,650.8392	12,530.0038	63	10,544.0517	12,736.0038
18	10,447.0182	12,942.4001	41	10,798.0517	12,801.0236	64	10,084.5653	12,781.7048
19	10,443.5786	13,002.4001	42	10,739.0517	12,800.1843			
20	10,437.8977	13,042.4001	43	10,678.0517	12,807.1622			
21	10,430.5985	13,122.4001	44	10,618.0517	12,818.8228			
22	10,428.8977	13,182.4001	45	10,558.0517	12,836.3471			
23	10,417.0421	13,242.4001	46	10,498.0517	12,851.8427			

Computer File Information Creation Date: 2/18/97 Initials: BEG Last Modification Date: 5/7/98 Initials: GLA Full Path: TR-KK D:\9671\JFSA Drawing File Name: 9671BORE.DWG Acad Ver: R13 Scale: 1:2000 Units: METRIC		Sheet Revisions <table border="1"> <tr><td>(R-1)</td><td></td></tr> <tr><td>(R-2)</td><td></td></tr> <tr><td>(R-3)</td><td></td></tr> <tr><td>(R-4)</td><td></td></tr> <tr><td>(R-5)</td><td></td></tr> </table>		(R-1)		(R-2)		(R-3)		(R-4)		(R-5)		Colorado Department of Transportation J. F. Sato and Associates 5898 South Platte Street Littleton, Colorado 80120 Phone: (303) 797-1200 FAX: (303) 797-1187 REGION NO. 4 SCE		As Constructed No Revisions: Revised: Void:		GEOLOGIC BORING LOGS Designer: AB Detailer: BEG Sheet Subset: BORING Subset Sheets: 1 of 4		Project No./Code IR-IM(CX) 025-3(111) 91034 Sheet Number 27	
(R-1)																					
(R-2)																					
(R-3)																					
(R-4)																					
(R-5)																					